



# Office of General Services

DESIGN & CONSTRUCTION GROUP  
THE GOVERNOR NELSON A. ROCKEFELLER  
EMPIRE STATE PLAZA  
ALBANY, NY 12242

---

## ADDENDUM NO. 2 TO PROJECT NO. Q1894

### CONSTRUCTION, HVAC, PLUMBING AND ELECTRICAL WORK RENOVATE 70 BEDROOM UNITS, HARDEN WALLS FINGER LAKES RESIDENTIAL CENTER 250 AUBURN ROAD LANSING, NY

October 23, 2025

**NOTE:** This Addendum forms a part of the Contract Documents. Insert it in the Project Manual. Acknowledge receipt of this Addendum in the space provided on the Bid Form.

#### GENERAL REQUIREMENTS - CONSTRUCTION WORK

1. SECTION 015213 STATE FIELD OFFICE: Add the accompanying Section (pages 015213 – 1 thru 015213 – 4) noted “Addendum No. 2”.

#### APPENDIX - CONSTRUCTION WORK

2. EF388 TEMPORARY TRAILERS RENTAL AND PREP QUOTE FROM WILLSCOT 14APR2025: Add the accompanying Document (pages 1 thru 3) to the Project Manual.

#### HVAC WORK SPECIFICATIONS

3. SECTION 237200 AIR-TO-AIR ENERGY RECOVERY UNITS: Discard the Section bound in the Project Manual and substitute the accompanying Section (pages 237200 – 1 thru 237200 – 8) noted “Addendum No. 2”.

#### PLUMBING WORK SPECIFICATIONS

4. SECTION 224600 SECURITY PLUMBING FIXTURES: Discard the Section bound in the Project Manual and substitute the accompanying Section (pages 224600 – 1 thru 224600 – 3) noted “Addendum No. 2”.

#### CONSTRUCTION WORK DRAWINGS

5. Addendum Drawings:
  - a. Drawing Nos. C-101 and C-102, noted “10/03/25 ADDENDUM 2” accompany this Addendum and form part of the Contract Documents.

**PLUMBING WORK DRAWINGS**

6. Revised Drawings:
  - a. Drawing P-001, noted “10/20/2025 ADDENDUM #2”, accompanies this Addendum and supersedes the same numbered originally issued drawing.

**ELECTRICAL WORK DRAWINGS**

7. Revised Drawings:
  - a. Drawing Nos. ES-001, ES-101, ES-102, ES-103 and ESD-103, noted “10/10/2025 ADDENDUM #2”, accompany this Addendum and supersede the same numbered originally issued drawings.

**END OF ADDENDUM**

Brady Sherlock, P.E.  
Director, Division of Design  
Design & Construction

## SECTION 015213

### STATE FIELD OFFICE (Incentive Space and Administrative Office – Temporary Trailers)

#### PART 1 GENERAL

##### 1.01 SECTION INCLUDES

- A. **Incentive Space and Administrative Office – Temporary Trailers.** Transfer lease agreement from Project Number (PN) EF388 to PN Q1894. PN EF388 Temporary trailers are comprised of custom built mobile or relocatable units, equipment, stair and ramp for the sole use of NYS Office of Children and Family Services (OCFS), Finger Lakes Residential Center staff and residents.
- B. Contractor is responsible for assuming the costs associated with the Incentive Space and Administrative Offices – Temporary Trailers units from PN EF388 within 45 days after award of the contract. Costs include demobilization and removal of the Incentive Space and Administrative Office – Temporary Trailers units. The current cost of the units is a monthly rental cost of \$7,254.29. Rental service provided by Willscot.

##### 1.02 RELATED WORK SPECIFIED ELSEWHERE

- A. Construction Facilities Temporary Controls: Section 015000.

##### 1.03 SCHEDULING

- A. Units are to remain on-site and operational through contract physical completion, or as directed.

##### 1.05 QUALITY ASSURANCE

- A. **Accessibility Requirements:** Units including stairs and ramps shall be maintained in compliance with ICC/ANSI A117.1 as referenced by the Building Code of New York State.
- B. Units and all related utility connections shall be maintained in accordance with the NYS Uniform Fire Prevention and Building Code.
- C. Certification insignia from New York Department of State that certifies trailer unit is code compliant.
- D. All service calls must be responded to within 24 hours.

#### PART 2 PRODUCTS – (SPECIFIED BY PN EF388 – To be included in lease transfer - for reference only)

## 2.01 MOBILE OR RELOCATABLE OFFICE UNITS

- A. Manufacturers/Companies:
1. ModSpace, 1620 Route 9, Clifton Park, NY 12065-0511, (518) 371-0384, [www.modspace.com](http://www.modspace.com).
  2. Williams Scotsman, Corporate Headquarters, 8211 Town Center Dr., Baltimore, MD 21236, (800) 782-1500, [www.willscot.com](http://www.willscot.com).
  3. Anchor Modular Buildings, PO Box 100, Medford, NJ 08055, (866) 396-0227, [www.anchormodular.com](http://www.anchormodular.com).
  4. Cassone, 1900 Lakeland Avenue, Ronkonkoma, NY 11779, (631) 585-7800, [www.cassone.com](http://www.cassone.com).
- B. Number, Approximate Size and Model:
1. One, 60 x 12 feet, single-wide Administrative Office
  2. One, 60 x 24 feet, double-wide Incentive Space
- C. Administrative Office Unit Requirements:
1. Administrative Office Unit trailer is a single trailer with two offices at each end with an open area in the middle of the trailer.
  2. Administrative Office Unit will not be hardened. It will be a standard trailer. No modifications to floorplan
  3. Interior Doors: Each office door to include vision panel.
  4. Electric energy for the duration of the Contract.
  5. Pre-wire unit for voice, data and security connections, to be coordinated with JCI.
  6. Each office will have a camera in them and two cameras in the open office area. Contractor to work with JCI on camera install and what is need for JCI cameras.
  7. Insulation: Exceed code required minimums for insulation. If wood frame construction, exceed the following values, walls > R - 11, floor > R - 19 and roof > R - 25. Provide code requirements and provided insulation values.
  8. Exterior Doors: Minimum 2, minimum 34 inches wide. Key and lockset to be provided by OCFS
  9. Windows: Approximately 7 percent of exterior wall area with insect screens (U-factor to exceed 0).
  10. Heating and Cooling: Complete ducted heating, ventilating, and air conditioning system with sufficient capacity to maintain a summer office temperature of 75 degrees F and a winter office temperature of 70 degrees F.
  11. VCT or sheet vinyl floor finish.
  12. Interior partitions to be wood 2 x 4 framing with ½” vinyl covered gypsum board.
  13. Light Fixtures: Fluorescent or LED lights in all rooms as required to maintain a minimum of 60-foot candles at desktop level.
  14. Skirting: Insulated skirting from bottom of units to grade, around entire unit. ½” thick wood, OSB, affixed with Security screws
- D. Incentive Space Unit Requirements:

1. Incentive Space Unit shall be a double wide trailer with two office areas at one end of the trailer. One office will be designated Incentive Space and the other designated Storage. The rest of the trailer shall be the Incentive Space: open space for instruction or recreation such as table games, etc.
2. Incentive Space office: The Incentive Space office shall include a 2'x 3' window looking out of the office to the open space in the trailer. The door to this office shall include a vision panel.
3. Storage office: Door to Storage office does not require a vision panel.
4. Electric energy for the duration of the Contract.
5. Pre-wire unit for voice, data and security connections, to be coordinated with JCI.
6. Incentive Space to have 4 security cameras; Incentive space, 2 security cameras; Storage space 1 camera. Contractor to work with JCI on camera install and needs for JCI cameras.
7. Insulation: Exceed code required minimums for insulation. If wood frame construction, exceed the following values, walls > R - 11, floor > R - 19 and roof > R - 25. Provide code requirements and provided insulation values.
8. Exterior Doors: Minimum 2, metal door slab, with either a break-proof side light or vision panel in door. Minimum 34 inches wide. Door Swing to ramp/stairs. Key and lockset to be provided by OCFS
9. Windows: Approximately 7 percent of exterior wall area (U-factor to exceed 0). Harden windows with 1/2" Lexan, fixed, secured with tamper-proof security fasteners.
10. Heating and Cooling: Complete ducted heating, ventilating, and air conditioning system with sufficient capacity to maintain a summer office temperature of 75 degrees F and a winter office temperature of 70 degrees F. Provide security protection over any exposed heating and cooling system.
11. Hardening: all walls, floors, and ceiling must have a hardening system applied, ie plywood or Lexan hardening behind walls, floors, and ceiling system. A drop ceiling is disallowed.
12. Light Fixtures: Security-grade interior Fluorescent or LED lights in all rooms as required to maintain a minimum of 60-foot candles at desktop level. Security-grade exterior light fixtures, one near each exterior door.
13. Skirting: Insulated skirting from bottom of units to grade, around entire unit. 1/2" thick wood, OSB, affixed with Security screws

## **2.02 FURNITURE AND EQUIPMENT**

- A. Furniture: as provided by the Office of Children and Family Services.
- B. Office Equipment: as provided by the Office of Children and Family Services.

## **PART 3 EXECUTION**

### **3.01 MAINTENANCE AND CLEANING**

- A. Maintain approaches free of mud and snow.

### **3.02 REMOVALS**

- A. Remove the Units when directed.
- B. Restore permanent facilities used for or connected to Incentive Space and Administrative Offices temporary trailers to their original condition or better.

**END OF SECTION**

**EF388 Temporary Trailers Rental and Prep Quote From Willscot 14Apr2025**



**Your Sales Representative**  
 Erich Omans  
 (315) 378-7489  
 erich.omans@willscot.com

**Agreement Number:** Q-2035856  
**Revision:** 2  
**Date:** 4/14/2025  
**Expiration Date:** 5/14/2025

**Master Lease Order**

<b>Lessee:0010397343</b> OGS 1220 WASHINGTON AVE ALBANY, NY 12226	<b>Contact:</b> Tanya Thorne 1220 WASHINGTON AVE ALBANY, NY 12226, US Phone: 515-565-8767 Email: tanya.thorne@ogs.ny.gov	<b>Ship To Address:</b> 250 Auburn Rd LANSING, NY 14882, US <b>Estimated Delivery Date :9/1/2025</b>
--	---	---

Rental Pricing Per Billing Cycle	Quantity	Price	Extended
60x24 Redi Plex (56x24 Box)	1	\$ 3,000.00	\$ 3,000.00
Loss Damage Waiver (11/12)	2	\$ 175.00	\$ 350.00
General Liability Insurance	1	\$ 30.00	\$ 30.00
Prof. Entrance - Steps w/ Canopy	1	\$ 100.00	\$ 100.00
ADA/IBC Switchback Ramp - 36ft & Larger	1	\$ 750.00	\$ 750.00
Window/Door Security Bundle - 40ft & Greater	2	\$ 75.00	\$ 150.00
Data Hub - Rental	2	\$ 75.00	\$ 150.00

Minimum Lease Billing Period: 18	Total Recurring Building Charges:	\$ 3,000.00
Billing Cycle : 28 days	Subtotal of Other Recurring Charges:	\$ 1,530.00
<b>Total Recurring Charges Per Billing Cycle:</b>		<b>\$ 4,530.00</b>
<b>Total Recurring Charges Per Billing Cycle Including Estimated Taxes:</b>		<b>\$ 4,890.71</b>

**Estimated Delivery And Installation**

Delivery - 12' wide	2	\$ 1,313.00	\$ 2,626.00
Return - 12' wide	2	\$ 1,313.00	\$ 2,626.00
Essentials Delivery Charge	1	\$ 510.00	\$ 510.00
Standard Complex Setup and Anchor	1	\$ 10,713.00	\$ 10,713.00
Standard Complex Skirting Removal	1	\$ 2,382.00	\$ 2,382.00
Standard Complex Vinyl Skirting	1	\$ 3,971.00	\$ 3,971.00
Standard Complex Knockdown	1	\$ 6,963.00	\$ 6,963.00
Modification to Unit L	1	\$ 20,000.00	\$ 20,000.00
Modification to Unit M	1	\$ 10,000.00	\$ 10,000.00
Delivery - Wide Load Escorts	2	\$ 350.00	\$ 700.00
Delivery - Wide Load Permits	2	\$ 125.00	\$ 250.00
Return - Wide load Escorts	2	\$ 350.00	\$ 700.00
Return - Wide load Permits	2	\$ 125.00	\$ 250.00
Fuel Surcharge Delivery	2	\$ 301.99	\$ 603.98
Fuel Surcharge Return	2	\$ 301.99	\$ 603.98
Ramp - Delivery & Installation	1	\$ 2,200.00	\$ 2,200.00
Ramp - Knockdown & Return	1	\$ 2,000.00	\$ 2,000.00
<b>Total Delivery and Installation Charges:</b>			<b>\$ 67,098.96</b>
<b>Total Delivery and Installation Charges Including Estimated Taxes:</b>			<b>\$ 72,466.88</b>

**Estimated Final Return Charges\***

<b>Due On Final Invoice*:</b>	\$ 0.00
<b>Due On Final Invoice Including Estimated Taxes*:</b>	\$ 0.00
<b>Total Including Recurring Billing Charges, Delivery, Installation and Return**:</b> \$ 148,638.96	
<b>Total Including Recurring Billing Charges, Delivery, Installation and Return Including Estimated Taxes**:</b> \$ 160,499.66	

**Summary of Charges**

Model: 60x24 Redi Plex (56x24 Box)	Quantity: 1	Total Charges for (1) Building(s): \$ 148,638.96
		Total Charges for (1) Building(s) Including Estimated Tax: \$ 160,499.66

**EF388 Temporary Trailers Rental and Prep Quote From Willscot 14Apr2025**



Your Sales Representative  
 Erich Omans  
 (315) 378-7489  
 erich.omans@willscot.com

Agreement Number: Q-2035856  
 Revision: 2  
 Date: 4/14/2025  
 Expiration Date: 5/14/2025

**Master Lease Order**

<b>Lessee:0010397343</b> OGS 1220 WASHINGTON AVE ALBANY, NY 12226	<b>Contact:</b> Tanya Thorne 1220 WASHINGTON AVE ALBANY, NY 12226, US Phone: 515-565-8767 Email: tanya.thorne@ogs.ny.gov	<b>Ship To Address:</b> 250 Auburn Rd LANSING, NY 14882, US <b>Estimated Delivery Date :9/1/2025</b>
--	---	---

Rental Pricing Per Billing Cycle	Quantity	Price	Extended
50x12 Mobile Office or Similar	1	\$ 900.00	\$ 900.00
Loss Damage Waiver (11/12)	1	\$ 175.00	\$ 175.00
General Liability Insurance	1	\$ 18.00	\$ 18.00
Prof. Entrance - Steps w/ Canopy	2	\$ 100.00	\$ 200.00
Window/Door Security Bundle - 40ft & Greater	1	\$ 75.00	\$ 75.00
Data Hub - Rental	1	\$ 75.00	\$ 75.00
ADA/IBC Switchback Ramp - 36ft & Larger	1	\$ 750.00	\$ 750.00
Minimum Lease Billing Period: 18	Total Recurring Building Charges:		\$ 900.00
Billing Cycle : 28 days	Subtotal of Other Recurring Charges:		\$ 1,293.00
<b>Total Recurring Charges Per Billing Cycle:</b>			<b>\$ 2,193.00</b>
<b>Total Recurring Charges Per Billing Cycle Including Estimated Taxes:</b>			<b>\$ 2,363.58</b>

**Estimated Delivery And Installation**

Ramp - Knockdown & Return	1	\$ 2,000.00	\$ 2,000.00
Delivery - 12' wide	1	\$ 1,313.00	\$ 1,313.00
Return - 12' wide	1	\$ 1,313.00	\$ 1,313.00
Essentials Delivery Charge	1	\$ 525.00	\$ 525.00
Standard Vinyl Skirting	1	\$ 2,938.00	\$ 2,938.00
Standard Setup and Anchor	1	\$ 1,620.00	\$ 1,620.00
Standard Skirting Removal	1	\$ 1,175.00	\$ 1,175.00
Standard Knockdown	1	\$ 891.00	\$ 891.00
Hitch removal	1	\$ 350.00	\$ 350.00
Modification to Unit L	1	\$ 10,000.00	\$ 10,000.00
Modification to Unit M	1	\$ 5,000.00	\$ 5,000.00
Fuel Surcharge Delivery	1	\$ 301.99	\$ 301.99
Fuel Surcharge Return	1	\$ 301.99	\$ 301.99
Ramp - Delivery & Installation	1	\$ 2,200.00	\$ 2,200.00
<b>Total Delivery and Installation Charges:</b>			<b>\$ 29,928.98</b>
<b>Total Delivery and Installation Charges Including Estimated Taxes:</b>			<b>\$ 32,323.30</b>

**Estimated Final Return Charges\***

Hitch installation	1	\$ 350.00	\$ 350.00
<b>Due On Final Invoice*:</b>			<b>\$ 350.00</b>
<b>Due On Final Invoice Including Estimated Taxes*:</b>			<b>\$ 378.00</b>

**Total Including Recurring Billing Charges, Delivery, Installation and Return\*\*:** \$ 69,752.98

**Total Including Recurring Billing Charges, Delivery, Installation and Return Including Estimated Taxes\*\*:** \$ 75,245.74

**Summary of Charges**

Model: 50x12 Mobile Office or Similar	Quantity: 1	Total Charges for (1) Building(s): \$ 69,752.98
		Total Charges for (1) Building(s) Including Estimated Tax: \$ 75,245.74



**Your Sales Representative**  
 Erich Omans  
 (315) 378-7489  
 erich.omans@willscot.com

**Agreement Number:** Q-2035856  
**Revision:** 2  
**Date:** 4/14/2025  
**Expiration Date:** 5/14/2025

**Billing & Payment Terms**

1. Lessor reserves the right to request Payment in advance of the Delivery Date, and Lessee may be required to make payment in advance to secure its performance of this Lease. Advance payments may include initial, final and/or recurring charges and will be applied to applicable invoices. Lessor reserves the right to charge an administrative fee for special billing requests.
2. Invoices will be generated on a 28 Day Billing Cycle, in advance, with payment due no later than Net 10 Days after invoice issuance.
3. AMOUNTS UNPAID WHEN DUE SHALL BE CHARGED INTEREST OF UP TO 1½% PER BILLING CYCLE OF THE UNPAID AMOUNT FOR THE PERIOD UNPAID, AND AN ADMINISTRATIVE CHARGE PER BILLING CYCLE THE INVOICE REMAINS UNPAID.
4. Initial Invoice Charges may include first and last Billing Cycle charges, delivery and installation charges, estimated charges for pick-up, teardown and Equipment removal, as well as any fuel surcharges. Final charges for pick-up, teardown and Equipment removal will be finalized at the time of pick-up based on existing site conditions. Upon the expiration of the Minimum Lease Term, the Lessor may make changes to the Lease rate, pick-up, teardown, removal, fuel surcharges and/or other charges.
5. The Initial Invoice will be issued on the earlier of the confirmation date or Delivery Date. In the event Lessee requests a delay to the delivery, as agreed to in the Confirmation, the Initial Invoice will be issued solely for the Equipment lease charges and a Storage Fee equal to 50% of the Lease, and all remaining Initial Invoice Charges will be invoiced on the Delivery Date. Lessee agrees that upon Termination prior to the Minimum Lease Term, Lessee shall pay the remaining payments for the unfulfilled Minimum Lease Term, and any applicable charges related to the Equipment, plus all return charges.

**Optional Insurance and Optional Coverage**

**General Liability Insurance**

If (a.) quoted on the pricing page(s) or (b.) initialed in the optional section of the pricing page(s), Customer elects to participate in the General Liability Insurance Program, whereby Lessee will receive insurance coverage through American Southern Insurance Company ("Insurer") and administered by Allen Insurance Group ("Agent"). The Lessee acknowledges and agrees that the policy issued by the Insurer is a third party liability policy that covers those amounts, subject to policy exclusions, that Lessee is legally obligated to pay due to bodily injury and property damage arising from the use and occupancy of Equipment leased from Lessor up to the policy limits. Coverage is subject to underwriting and specific terms and conditions and exclusions set forth in the policy. An outline of coverage is available upon request.

**Loss Damage**

If (a.) quoted on the pricing page(s) or (b.) initialed in the optional section of the pricing page(s), Lessee elects to participate in the Loss Damage Waiver Program. Lessee understands and agrees that under this program and subject to any exclusions, the Lessor waives, for a fee, Lessee's obligation to carry Commercial Property Insurance and Lessee's liability for repair or replacement of the Equipment leased from Lessor resulting in loss or damage. Please refer to the LOSS DAMAGE WAIVER PROGRAM ADDENDUM for specific details on coverage, exclusions and restrictions on coverage. The Loss Damage Waiver is not and shall not constitute a contract for insurance.

**Contents Insurance**

If (a.) quoted on the pricing page(s) or (b.) initialed in the optional section of the pricing page(s), Lessee elects to participate in the Contents Insurance Coverage Program, whereby Lessee will receive insurance coverage through Airpark Insurance ("Insurer") and administered by Falvey Insurance Group, Ltd. ("Falvey") as Managing General Agent of those Interested Underwriters at Lloyd's, London ("Agent"). The Lessee acknowledges and agrees that the policy issued by the Insurer is a third party property policy that, subject to policy exclusions, provides comprehensive contents coverage and adds an additional layer of protection for the stored contents up to the selected limit of coverage. Coverage is subject to underwriting and specific terms and conditions and exclusions set forth in the policy. An outline of coverage is available upon request.

**Terms & Conditions**

Lessee hereby acknowledges and agrees to be bound by the Master Equipment Lease Agreement dated [1/16/2024] between the Lessee and Lessor in its entirety, which is incorporated herein by reference, and Lessee agrees to Lease the Equipment from Lessor subject to the terms therein.

**Acceptance and Authority**

Lessee represents and warrants they have the authority to agree to the terms and conditions stated in this Agreement by (1) signing this document, (2) executing an Order that references this Agreement, (3) taking delivery of the Equipment, or (4) other commercially acceptable means methods and, by doing so, this Agreement shall become legally binding. Lessor will consider the Order rejected if changes have been made to the Order by Lessee.

**Lessee: OGS**

Signature:	Date:
Print Name:	Title:
PO#:	

## SECTION 237200

### AIR-TO-AIR ENERGY RECOVERY UNITS

#### PART 1 GENERAL

##### 1.01 SUMMARY

- A. This Section includes the following:
  - 1. Packaged energy recovery units.

##### 1.02 SUBMITTALS

- A. Product Data for each energy recovery unit specified, including the following:
  - 1. Certified supply and exhaust fans performance curves with system operating conditions indicated.
  - 2. Certified fans sound power ratings.
  - 3. Certified heat recovery component (i.e., heat wheels, heat-pipe heat exchangers, etc.) rated capacities for inlet and outlet operating conditions, and operating efficiencies indicated.
  - 4. Certified coil-performance ratings with system operating conditions indicated.
  - 5. Motor ratings and electrical characteristics plus motor and fan accessories.
  - 6. Material gages and finishes.
  - 7. Filters with performance characteristics.
  - 8. Dampers, including housings, linkages, and operators.
  - 9. Weights (shipping, installed, and operating).
  - 10. Furnished specialties.
  - 11. All required accessories.
  - 12. Installation and startup instructions.
- B. Shop Drawings from manufacturer detailing equipment assemblies and indicating dimensions, weights, loadings, required clearances, method of field assembly, components, and location and size of each field connection.
  - 1. Wiring diagrams detailing wiring for power and control systems and differentiating between manufacturer-installed and field-installed wiring.
- C. Field test reports indicating and interpreting test results relative to compliance with specified requirements.
- D. Coordination Drawings: Reflected ceiling plans drawn to scale and coordinating penetrations and ceiling-mounted items. Show the following:
  - 1. Ceiling suspension assembly members.
  - 2. Method of attaching hangers to building structure.
  - 3. Size and location of initial access modules for acoustical tile.
  - 4. Other ceiling-mounted items including light fixtures, diffusers, grilles, speakers, sprinklers, access panels, and special moldings.

- E. Maintenance data for each energy recovery unit, control, and accessory to include in the operation and maintenance manual specified in Division 1. Include instruction for lubrication, filter replacement, motor and drive replacement, spare parts lists, and wiring diagrams.
- F. Manufacturer's Warranty to include manufacturer's standard form with agreement to repair or replace components of water source heat pump units that fail in materials or workmanship within specified warranty period. Warranty period shall be a minimum of 5 years from date of Substantial Completion.

### **1.03 QUALITY ASSURANCE**

- A. Regulatory Requirements: Comply with provisions of the following codes:
  - 1. ASHRAE Compliance: Provide capacity ratings for energy recovery devices according to ASHRAE 84, "Method of Testing Air-to-Air Heat Exchangers."
  - 2. NRCA Compliance: Provide roof curbs for roof-mounted equipment constructed according to recommendations of NRCA.
- B. Testing Requirements: The following factory tests are required:
  - 1. Sound Power Level Ratings: Comply with AMCA 301, "Methods for Calculating Fan Sound Ratings from Laboratory Test Data." Test fans according to AMCA 300, "Reverberant Room Method for Sound Testing of Fans." Fans shall bear AMCA-certified sound ratings seal.
  - 2. Fan Performance Ratings: For fans product data submitted, establish flow rate, pressure, power, air density, speed of rotation, and efficiency by factory tests and ratings in accordance with AMCA Standard 210/ASHRAE Standard 51 - Laboratory Methods of Testing Fans for Rating.
- C. NFPA Compliance: Central-station air-handling units and components shall be designed, fabricated, and installed in compliance with NFPA 90A, "Installation of Air Conditioning and Ventilating Systems."
- D. UL Standard: Provide units complying with UL 1812, "Ducted Heat Recovery Ventilators"; or UL 1815, "Nonducted Heat Recovery Ventilators."
- E. UL and NEMA Compliance: Provide ancillary electrical components, such as motors, required as part of energy recovery units that are listed and labeled by UL and that comply with applicable NEMA standards.
- F. Comply with NFPA 70 for components and installation.
- G. AHRI Compliance: Air to air energy recovery components shall comply with AHRI 1060.
- H. ARI Compliance: Coils shall be rated in accordance with ARI standard 410 and bear the ARI seal.

- I. Listing and Labeling: Provide electrically operated components specified in this Section that are listed and labeled.
  - 1. The Terms “Listed” and “Labeled”: As defined in the National Electrical Code, Article 100.
- J. Coordination: Coordinate layout and installation of energy recovery units with piping and ductwork and with other installations.

#### **1.04 DELIVERY, STORAGE, AND HANDLING**

- A. Deliver energy recovery unit as a factory-assembled module with protective crating and covering.
- B. Lift and support units with manufacturer’s designated lifting or supporting points.

#### **1.05 SEQUENCING AND SCHEDULING**

- A. Coordinate size and location of concrete housekeeping bases. Cast anchor-bolt inserts into base. Concrete reinforcement and formwork requirements are specified in Division 3 sections.
- B. Coordinate installation of roof curbs, equipment supports, and roof penetrations.

#### **1.06 ENVIRONMENTAL REQUIREMENTS**

- A. Do not operate units for any purpose, temporary or permanent, until ductwork is clean, filters are in place, bearings lubricated, and fan has been test run under observation.

#### **1.07 EXTRA MATERIALS**

- A. Furnish extra materials described below that match products installed, are packaged with protective covering for storage, and are identified with labels describing contents.
- B. Filters: Furnish one set of each type of filter specified.
- C. Fan Belts: Furnish one set of belts for each belt-driven fan in energy recovery units.
- D. Wheel Belts: Furnish one set of belts for each heat wheel.

### **PART 2 PRODUCTS**

#### **2.01 MANUFACTURERS**

- A. Manufacturers: Subject to compliance with requirements, provide products by one of the following:

1. SEE EDITING INSTRUCTION NO. 1 IN THE EVALUATIONS FOR CAUTIONS ABOUT NAMING PRODUCTS AND MANUFACTURERS.
2. Packaged Energy Recovery Units:
  - a. Carnes Co., Inc.
  - b. Conservation Energy Systems.
  - c. Des Champs Laboratories Inc.
  - d. Gaylord Industries, Inc.
  - e. Munters Cargocaire.
  - f. QDT Ltd.
  - g. RenewAire LLC
  - h. SEMCO Inc.
  - i. Venmar Ventilation Inc.
  - j. Innovent Air Handling Equipment

## 2.02 PACKAGED ENERGY RECOVERY UNITS

- A. Housing: Galvanized steel panels fastened to structural-steel or formed galvanized steel internal frame, gasketed and calked weather tight; with waterproof floor, manufacturer's standard paint finish, and lifting lugs. Panels shall be fabricated to allow removal for access to internal parts and components, with joints between sections sealed Thermal break construction: The entire casing, excluding doors, must be built such that no member on the exterior of the unit, excluding fasteners, has through metal contact with any member on the interior of the unit, excluding fasteners.
  1. Outside Casing: Aluminum, 0.063 inch (1.6 mm).
  2. Outside Casing: Steel, 0.0598 inch (1.5 mm).
  3. Outside Casing: Galvanized steel, 0.0516 inch (1.3 mm).
  4. Outside Casing: Galvanized steel, 0.0635 inch (1.61 mm).
- B. Access Doors: Same materials and finishes as cabinet and complete with hinges, latches, handles, and gaskets. At a minimum, provide double-wall insulated, one side hinged with minimum of 2-cam latches operated from either side.
- C. Heat Wheel: Corrugated aluminum strengthened with radial spokes, with nontoxic, noncorrosive silica-gel desiccant coating. Construct media for passing maximum 800-micron solids and maximum 0.04 percent cross contamination by volume of exhaust air. Drive rotor with belt around outside of rotor. Provide total heat wheel with minimum sensible and latent capacities, and minimum efficiency as scheduled on drawings. Provide the following:
  1. Integral purge section.
  2. Casing seals on periphery of rotor, on duct divider and on purge section.
  3. Support rotor on grease-lubricated ball bearings with extended grease fittings. Mount horizontal wheels on tapered roller bearing.
  4. Rotor: Corrugated aluminum strengthened with radial spokes, with nontoxic, noncorrosive silica-gel desiccant coating. Construct media for passing maximum 800-micron solids and maximum 0.04 percent cross contamination by volume of exhaust air. Drive rotor with belt around outside of rotor.
  5. Drive: Variable-speed, fractional horsepower motor and gear reducer, with speed changed from SCR (silicon-controlled rectifier) controller.

6. **Controllers:** Provide a panel, factory mounted and wired to motor with airstream thermostat and manual motor starter for field wiring; with pilot-light indication of rotor rotation and provisions for setting maximum and minimum speed. Rotate wheel at variable speed controlled by discharge thermostat, summer/winter changeover thermostat, and SCR controller. Provide control panel containing ON-OFF switch, AUTO-MANUAL switch, manual speed adjustment, and indicating light. Panel shall have an LCD screen and keypad for user interface mounted on the unit it is controlling.
  7. **Rotation Detection:** Provide alarm device to signal rotation failure, with set of contacts for alarm-circuit field wiring. Device to include electronic control module, electromagnetic sensor, and iron shuttle factory wired and mounted, with alarm bell for field wiring and mounting.
- D. **Supply and Exhaust Fans:** Provided by manufacturer integral to packaged energy recovery unit as scheduled, with spring isolation base and flexible duct connections, adjustable belt drives, and motors on adjustable motor bases. Fan assemblies shall be statically and dynamically balanced and designed for continuous operation at maximum rated fan speed and motor power. Fan section assemblies include fan wheels, shafts, bearings, drives, belts, isolation bases, and isolators.
- E. **Motors:**
1. **Torque Characteristics:** Sufficient to accelerate driven loads satisfactorily.
  2. **Motor Sizes:** Minimum size as indicated. If not indicated, large enough so driven load will not require motor to operate in service factor range.
  3. **Temperature Rating:** 50 DegC maximum temperature rise at 40 DegC ambient for continuous duty at full load (Class A Insulation).
  4. **Service Factor:** 1.15 for polyphase motors and 1.35 for single-phase motors.
  5. **Motor Construction:** NEMA MG-1, general purpose, continuous duty, Design B. Provide adjustable base.
  6. **Overload Protection:** Built-in, automatic reset, thermal overload protection.
  7. **Noise Rating:** Quiet.
  8. **Efficiency:** Energy-efficient motors shall have a minimum efficiency as scheduled according to IEEE 112, Test Method B. If efficiency is not specified, motors shall have a higher efficiency than “average standard industry motors” according to IEEE 112, Test Method B.
    - a. Provide premium efficiency motors.
  9. **Nameplate:** Indicate full identification of manufacturer, ratings, characteristics, construction, and special features.
- F. **Dampers:** Provide low leakage dampers. Leakage rate, according to AMCA 500, “Test Methods for Louvers, Dampers and Shutters,” shall not exceed 2 percent of air quantity at 2000-fpm (10-m/s) face velocity through damper and 4-inch w.g. (1000-Pa) pressure differential.
1. **Damper operators** shall be pneumatically operated and shall be factory mounted and provided by manufacturer.

2. Damper operators shall be electrically operated and shall be factory mounted and provided by manufacturer.
- G. Permanent Filters: Cleanable, 2 inches (50 mm) thick, with aluminum- or stainless-steel media and stainless-steel frames, clean airflow resistance of 0.10 inch wg (25 Pa) at face velocity of 500 fpm (2.54 m/s), and ASHRAE 52.1 filter-arrestance efficiency of 60 to 80 percent. Filters shall be mounted in a galvanized steel slide rack and sized for 500 FPM maximum face velocity. Provide filter media holding frames arranged for flat or angular orientation; provide access doors on both sides of unit
1. Outside Air (Inlet) Filters: 2-inch MERV 8
  2. Return Air Filters: 2-inch MERV 8
  3. Supply Air (Outlet) Filter: 12-inch MERV 13
- H. Disposable Filters: 2 inches (50 mm) thick, viscous-coated fibers encased in fiberboard cell with perforated-metal media support, clean airflow resistance of 0.10 inch wg (25 Pa) at face velocity of 300 fpm (1.52 m/s) and ASHRAE 52.2 filter-arrestance efficiency of 70 to 82 percent. Provide in galvanized steel frame, upstream of unit in both supply and exhaust airstreams, with maximum 500 FPM face velocity.
1. Filters comply with NFPA 90A.
  2. Filter Section: Provide filter media holding frames arranged for flat or angular orientation; provide access doors on both sides of unit.
- I. Piping and Wiring: Fabricate units with space within housing for piping and electrical conduits. Wire motors and controls so only external connections are required during installation.
- J. Power: Provide packaged unit with single power point connection and thru the door factory mounted disconnect switch.
- K. Unit Mounted Display and Keypad: Provide from the factory a controller with an LCD screen and keypad for user interface mounted on the unit it is controlling. System passwords are required to prevent unauthorized use. A portable service tool is acceptable, but one must be permanently mounted at each packaged energy recovery unit. Local access to packaged energy recovery unit status, setpoints, and alarms is critical. No exceptions will be permitted. Controller shall be factory programmed with standard sequences of operation.
1. Unit shall operate continuously at design airflow.

## **PART 3 EXECUTION**

### **3.01 EXAMINATION**

- A. Examine areas to receive energy recovery units for compliance with requirements for installation tolerances and other conditions affecting performance of energy recovery units. Examine roughing-in of condensate drainage piping and electrical to verify actual locations of connections before installation. Do not proceed with installation until unsatisfactory conditions have been corrected.

### **3.02 INSTALLATION**

- A. Install indoor energy recovery units as indicated, plumb and level and according to manufacturer's written instructions.
  - 1. Floor-Mounted Units: Support on minimum equipments bases using housed-spring isolators.
- B. Install heat wheels so supply and exhaust flow in opposite directions and rotation is from exhaust side to purge section to supply side.
  - 1. Provide access doors in both supply and exhaust ducts, both upstream and downstream, for access to wheel surfaces, drive motor, and seals.
  - 2. Provide removable panels or access doors between supply and exhaust ducts on building side for bypass during startup.
- C. Arrange installation of units to provide access space around equipment for service and maintenance.
- D. Install new filters at completion of equipment installation and before testing, adjusting, and balancing.

### **3.03 CONNECTIONS**

- A. Drawings indicate the general arrangement of ducts and duct accessories. Make final duct connections with flexible connections.

### **3.04 CLEANING**

- A. After completing system installation, including outlet fittings and devices, inspect and clean exposed finishes. Remove burrs, dirt and construction debris, and repair damaged finishes including chips, scratches and abrasions
- B. Clean fan interiors to remove foreign material and construction dirt and dust. Vacuum clean fan wheels, cabinets, and heat recovery equipment air face areas.

### **3.05 COMMISSIONING**

- A. Manufacturer's Field Inspection: Engage a factory-authorized service representative to perform the following:
  - 1. Inspect field assembly of components and installation of equipment including piping, ductwork, and electrical connections.
  - 2. Prepare a written report on findings and recommended corrective actions.
- B. Final Checks before Startup: Perform the following before startup:
  - 1. Verify that shipping, blocking, and bracing are removed.
  - 2. Verify that unit is secure on curbs, mountings and supporting devices and that connections for piping, ductwork, and electrical are complete. Verify that proper thermal overload protection is installed in motors, starters and disconnects.
  - 3. Perform cleaning and adjusting specified in this Section.

4. Disconnect fan drive from motor, verify proper motor rotation direction, and verify free fan wheel rotation and smooth bearings operations. Reconnect fan drive system, align belts, and install belt guards.
  5. Disconnect heat recovery wheel drives from motors and verify heat recovery wheel rotation and smooth bearings operations. Reconnect wheel drive system, align belts, and install belt guards.
  6. Lubricate bearings, pulleys, belts, and other moving parts with factory-recommended lubricants.
  7. Set zone dampers to fully open position for each zone.
  8. Set face-and-bypass dampers to full face flow.
  9. Set outside-air and return-air mixing dampers to minimum outside-air setting.
  10. Inspect energy recovery component and confirm there is no damage or operational issues.
  11. Install clean filters.
  12. Verify that manual and automatic volume control, and any fire and smoke dampers in connected ductwork systems are in fully open position.
- C. Startup Services: Engage a factory-authorized service representative to commission units as specified below.
1. Energize and verify correct rotation of heat wheels and fans.
  2. Adjust seals and purge.
  3. Test and adjust controls and safeties. Replace damaged or malfunctioning controls and equipment.
  4. Prepare a written report on commissioning checklists and startup procedures.

### **3.06 DEMONSTRATION**

- A. Train Director's Representative maintenance personnel on procedures and schedules related to startup and shutdown, troubleshooting, servicing, and preventive maintenance.
- B. Review data in the operation and maintenance manuals.
- C. Schedule training with Director's Representative with at least 7 days' advance notice.

**END OF SECTION**

## SECTION 224600

### SECURITY PLUMBING FIXTURES

#### PART 1 GENERAL

##### 1.01 PRODUCTS FURNISHED BUT NOT INSTALLED UNDER THIS SECTION

- A. Deliver the following items to the Construction Work Contractor for installation:
  - 1. Wall sleeves for wall mounted stainless steel fixtures.
    - a. Coordinate locations and openings required for sleeves with the Construction Work Contractor.

##### 1.02 RELATED WORK SPECIFIED ELSEWHERE

- A. Sealants: Section 079200.

##### 1.03 SUBMITTALS

- A. Product Data: Catalog sheets, specifications, roughing dimensions, and installation instructions for each item specified except fasteners.

##### 1.04 QUALITY ASSURANCE

- A. Regulatory Requirements:
  - 1. Comply with applicable requirements of FS WW-P-541, and the following standards:
  - 2. Materials and installations designated as handicapped accessible shall conform with the following:
    - a. ANSI A117.1 - Buildings and Facilities - Providing Accessibility and Usability for Physically Handicapped People.
    - b. The Americans with Disabilities Act Accessibility Guidelines for Buildings and Facilities (ADAAG), (Appendix A to 28 CFR Part 36).
    - c. The Uniform Federal Accessibility Standards (UFAS), (Appendix A to 41 CFR Part 101-19.6).
  - 3. Each fixture carrier support shall be listed by model number in the fixture support manufacturer's Fixture Support Selection Guide as being recommended for support of the appropriate fixture.
- B. Plainly and permanently mark each fixture and fitting with the manufacturer's name or trade mark.
- C. Acid resistant surfaces shall be plainly and permanently marked with the manufacturer's label or symbol indicating acid resistance.

## 1.05 MAINTENANCE

- A. Special Tools: Deliver to the Director's Representative.
  - 1. Furnish the following tools labeled with names and locations where used.
    - a. Keys for stops (furnished with stops).
    - b. Tools for Vandal Resistant Fasteners: Two for each type and size.

## PART 2 PRODUCTS

### 2.01 MATERIALS - GENERAL

- A. Stainless Steel: AISI Type 304, 14 gauge, satin finish, except as otherwise specified.
- B. Fixture Trim: Brass, bronze, or stainless steel construction; consisting of supply and waste fittings, faucets, traps, stop valves, escutcheons, sink strainers, nipples, supplies, and metal trim.
  - 1. Brass piping: Ips standard weight, with standard weight, 125 lb cast brass fittings.
  - 2. Brass tubing: 18 B & S gage.
  - 3. Stainless steel: 18-8 AISI Type 302 or 304 unless otherwise specified.
- C. Fixture Trim Finishes:
  - 1. Brass or Bronze: Polished or satin finished chrome plating, 0.02 mil chromium over 0.2 mil nickel plating.
  - 2. Stainless Steel: Invisible welds and seams, and unless otherwise specified, polished to No. 4 commercial finish.
- D. Combination Faucets: Faucets shall turn counter to each other for the on and off positions.
- E. Vandal Resistant Fasteners: Torx head with center pin.

### 2.02 STAINLESS STEEL COMBINATION SECURITY FIXTURES

- A. Acorn's Model 1418-\*\*-2-04-M-BRS-FVH-FVT-SW Combination Security Type Lavatory-Water Closet, with toilet angled left (\*\* = AL), angled right (\*\* = AR), or centered (\*\* = CT) as indicated,, and with the following features:
  - 1. Toilet:
    - a. Hydraulic Flush Valve; Water consumption 1.28 gallons of water or less per flush.
    - b. Blowout type, concealed wall supply, off-floor mounting, wall outlet.
    - c. Seamless welded Type 304 stainless steel construction, with satin finished exterior except integral contoured seat shall have sanitary high polished finish.
    - d. Elongated bowl.

- e. Trap: Minimum 3-1/2 inch seal, capable of passing a 2-1/8 inch ball. Waste outlet 2-3/8 inch diameter, plain end.
- 2. Lavatory:
  - a. Oval bowl.
  - b. Penal type bubbler/filler.
  - c. Pneumatically operated hot and cold water push-button valves, metering non-hold open type, requiring less than 5 lbs force to activate.
- 3. Fixture shall withstand loadings up to 2,000 lbs with no measurable deflection, and loadings up to 5,000 lbs with no permanent damage.
- 4. Wall sleeve, minimum 12 gauge galvanized steel, with 1/2 inch dia continuous steel bars, on maximum 6 inch centers, penetrating frame, welded in place, and extending 2 inches out from sides for embedment in walls. Provide with required fasteners, all as furnished by fixture manufacturer.
  - a. Use vandal resistant fasteners if and where exposed.

### **2.03 TEMPLATES**

- A. One for each type of wall mounted stainless steel penal type fixture specified.

## **PART 3 EXECUTION**

### **3.01 FIXTURE INSTALLATION**

- A. Install the Work of this section in accordance with the manufacturer's printed installation instructions.
- B. Install fixtures level and at proper height, tighten connections, and install hold-down bolts, cap nuts and cover plates, where required.
- C. Secure exposed external components in place with vandal resistant fasteners or devices which cannot be removed without the use of special tools.

### **3.02 CLEANING, FLUSHING AND ADJUSTMENT**

- A. Clean fixture and trim. Remove grease and dirt; polish surfaces but leave stickers and warning labels intact.
- B. Flush supply piping and traps; clean strainers.
- C. Adjust stops for proper delivery.
- D. Adjust metering faucets for proper timing.

**END OF SECTION**



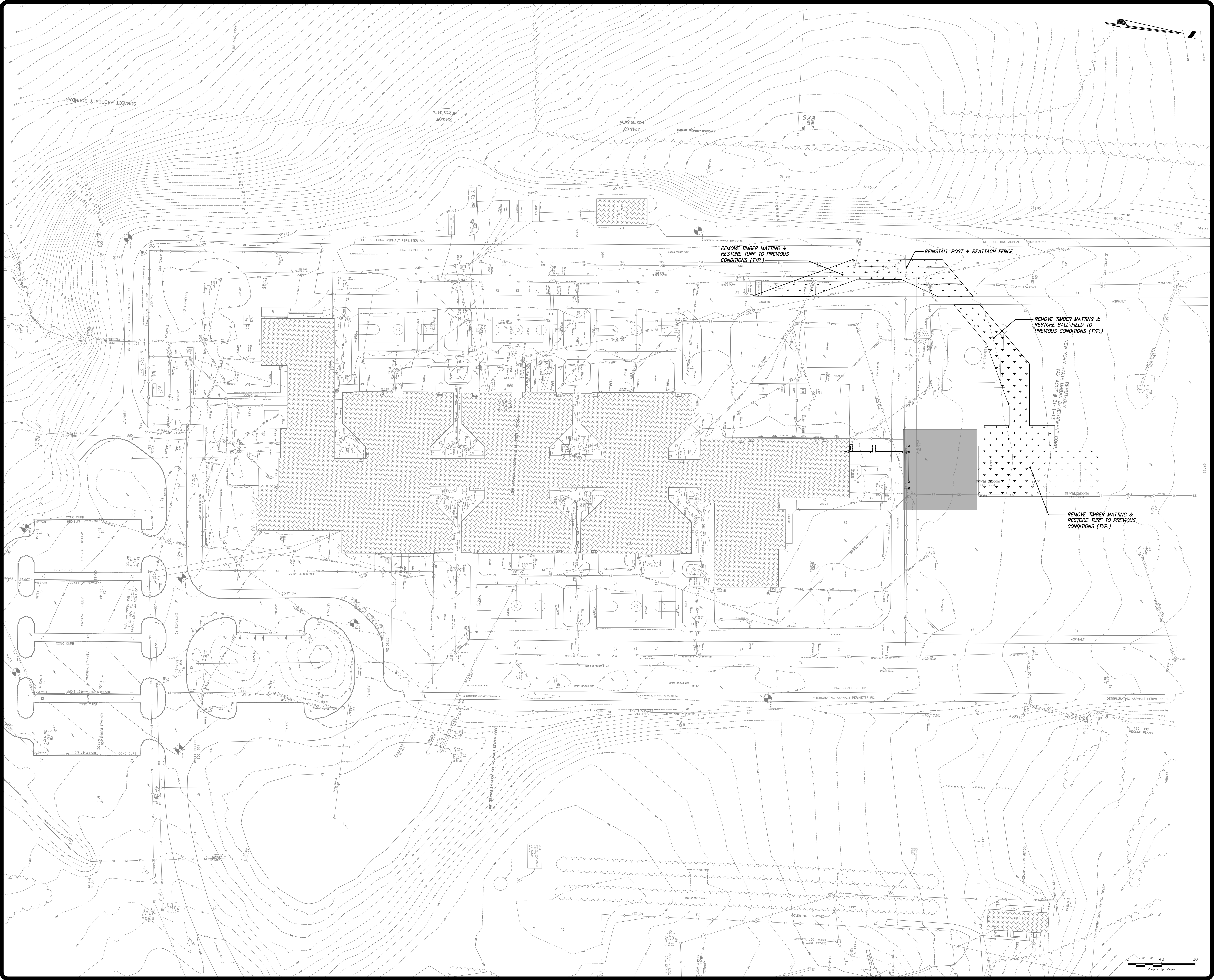

UNIFORM CODE STATEMENT:  
 TO THE BEST OF REGISTERED DESIGN PROFESSIONALS KNOWLEDGE, BELIEF, AND PROFESSIONAL JUDGMENT, THESE PLANS AND/OR SPECIFICATIONS ARE IN COMPLIANCE WITH 2020 UNIFORM CODE.

ENERGY CODE COMPLIANCE STATEMENT:  
 TO THE BEST OF THE REGISTERED DESIGN PROFESSIONALS KNOWLEDGE AND BELIEF AND JUDGMENT, THESE PLAN AND/OR SPECIFICATIONS ARE IN COMPLIANCE WITH THE 2020 ENERGY CODE.

**WARNING:**  
 THE ALTERATION OF THIS MATERIAL IN ANY WAY, UNLESS DONE UNDER THE DIRECTION OF A COMPARABLE PROFESSIONAL, O.E. ARCHITECT FOR AN ARCHITECT, ENGINEER FOR AN ENGINEER OR LANDSCAPE ARCHITECT FOR A LANDSCAPE ARCHITECT, IS A VIOLATION OF THE NEW YORK STATE EDUCATION LAW AND/OR REGULATIONS AND IS A CLASS 'A' MISDEMEANOR.

  
 REGISTERED PROFESSIONAL ENGINEER

**CONTRACT:** CONSTRUCTION  
**TITLE:** RENOVATE 70 BEDROOM UNITS, HARDEN WALLS  
**LOCATION:** FINGER LAKES RESIDENTIAL CENTER  
 250 AUBURN RD,  
 LANSING, NY  
**CLIENT:** OFFICE OF CHILDREN AND FAMILY SERVICES

1	10/03/2025	ADDENDUM 2
0	12/24/2024	BID DOCUMENTS
MARK	DATE	DESCRIPTION
PROJECT NUMBER:	Q1894-C	
DESIGNED BY:	TJB	
DRAWN BY:	TSZ	
FIELD CHECK:		
APPROVED:	SKB	
SHEET TITLE:	TEMPORARY ACCESS ROAD REMOVAL AND RESTORATION	
DRAWING NUMBER:	C-102	
SHEET:	OF	

SHEET SIZE 30" x 42". DRAWING IS NOT TO SCALE WHEN PRINTED IN ALL OTHER SHEET SIZES.

Autodesk Docs://085008 OGS 01894 Finger Lakes Wall Hardening of 70 Bedroom Units/085008-PL/UM23-CENTRAL.rvt  
10/19/2023 3:18:19 PM  
30x42 PLOT SHEET

CONSULTANT:  
CERTIFICATE OF AUTHORIZATION #: 0021745



**UNIFORM CODE STATEMENT:**  
TO THE BEST OF THE REGISTERED DESIGN PROFESSIONAL'S KNOWLEDGE, BELIEF, AND PROFESSIONAL JUDGEMENT, THESE PLANS AND/OR SPECIFICATIONS ARE IN COMPLIANCE WITH THE 2020 UNIFORM CODE.

**ENERGY CODE COMPLIANCE STATEMENT:**  
TO THE BEST OF THE REGISTERED DESIGN PROFESSIONAL'S KNOWLEDGE, BELIEF, AND PROFESSIONAL JUDGEMENT, THESE PLANS AND/OR SPECIFICATIONS ARE IN COMPLIANCE WITH THE 2020 ENERGY CODE.

**WARNING:**  
THE ALTERATION OF THIS MATERIAL IN ANY WAY, UNLESS DONE UNDER THE DIRECTION OF A COMPARABLE PROFESSIONAL, I.E. ARCHITECT FOR AN ARCHITECT, ENGINEER FOR AN ENGINEER OR LANDSCAPE ARCHITECT FOR A LANDSCAPE ARCHITECT, IS A VIOLATION OF THE NEW YORK STATE EDUCATION LAW AND/OR REGULATIONS AND IS A CLASS B MISDEMEANOR.

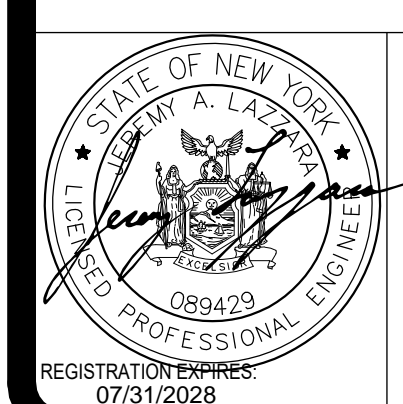

**CONTRACT:** PLUMBING  
**TITLE:** RENOVATE 70 BEDROOM UNITS, HARDEN WALLS  
**LOCATION:** FINGER LAKES RESIDENTIAL CENTER  
250 AUBURN RD,  
LANSING, NY  
**CLIENT:** OFFICE OF CHILDREN AND FAMILY SERVICES

MARK	DATE	DESCRIPTION
1	10/20/2025	ADDENDUM #2
0	10/24/2024	BID DOCUMENTS

**PROJECT NUMBER:** Q1894-P  
**DESIGNED BY:** JDH  
**DRAWN BY:** DMF  
**FIELD CHECK:**  
**APPROVED:**  
**SHEET TITLE:**

**LEGEND, ABBREVIATIONS AND SYMBOLS**

**DRAWING NUMBER:** P-001  
**SHEET:** OF

PLUMBING ABBREVIATIONS	
ABS	ABSOLUTE
AC	ALTERNATING CURRENT
AD	ACCESS DOOR
AFF	ABOVE FINISHED FLOOR
AP	ACCESS PANEL
BOP	BOTTOM OF PIPE
CD	CONDENSATE DRAIN
CLG	CEILING
Cv	COEFFICIENT, VALVE FLOW
DN	DOWN
EC	ELECTRICAL CONTRACTOR
ELEV	ELEVATION
ESP	EXTERNAL STATIC PRESSURE
EWC	ELECTRIC WATER COOLER
EWT	ENTERING WATER TEMPERATURE
F&T	FLOAT AND THERMOSTATIC TRAP
FAI	FRESH AIR INTAKE
FF	FINISHED FLOOR
FLA	FULL LOAD AMPS
FLR	FLOOR
FT HD	FEET OF HEAD
GA	GAUGE OR GAGE
GAL	GALLON
GPH	GALLONS PER HOUR
GPM	GALLONS PER MINUTE
HP	HORSEPOWER
HTHW	HIGH TEMPERATURE HOT WATER
IN	INCH
IN WG	INCHES WATER GAUGE
INV	INVERT
LAV	LAVATORY
LF	LINEAR FEET/FOOT
LTHW	LOW TEMPERATURE HOT WATER
LWT	LEAVING WATER TEMPERATURE
MAX	MAXIMUM
MBH	BTU PER HOUR (THOUSAND)
MH	MANHOLE
MCA	MINIMUM CIRCUIT AMPS
MIN	MINIMUM
MIN SP	MINIMUM STATIC PRESSURE
MOC	MAXIMUM OVERCURRENT PROTECTION
MTG HGT	MOUNTING HEIGHT
MO	MASONRY OPENING
MV	MANUAL AIR VENT
N/A	NOT APPLICABLE
N C	NORMALLY CLOSED
NIC	NOT IN CONTRACT
N O	NORMALLY OPEN
NPW	NON POTABLE WATER
PC	PLUMBING CONTRACTOR
PD	PRESSURE DROP
PH	PHASE
PPM	PARTS PER MILLION
PSIG	POUNDS PER SQUARE INCH GAUGE
RPM	REVOLUTIONS PER MINUTE
SP	STATIC PRESSURE
TD OR ΔT	TEMPERATURE DIFFERENCE
TDH	TOTAL DIFFERENTIAL HEAD
TEMP	TEMPERATURE
THR	TOTAL HEAD REJECTION
TSP	TOTAL STATIC PRESSURE
UNO	UNLESS NOTED OTHERWISE
UR	URINAL
VOLT	VOLTAGE
VTR	VENT THROUGH ROOF
W	WATT
WBT	WET BULB TEMPERATURE
WC	WATER CLOSET
WG	WATER GAUGE
WPD	WATER PRESSURE DROP
°F	DEGREES FAHRENHEIT
#	AND NUMBER

PLUMBING LINE-TYPES (ONE-LINE)	
--- Z" R ---	REMOVE PIPING (SIZE AS INDICATED)
--- Z" (E)CW ---	EXISTING PIPING (SIZE AND SYSTEM AS INDICATED)
--- Z" CA ---	COMPRESSED AIR PIPING (SIZE AS INDICATED)
--- Z" CW ---	COLD WATER PIPING (SIZE AS INDICATED)
--- Z" HW ---	HOT WATER PIPING (SIZE AS INDICATED)
--- Z" HWR ---	HOT WATER RETURN PIPING (SIZE AS INDICATED)
--- Z" SAN ---	SANITARY PIPING (SIZE AS INDICATED)
--- Z" ST ---	STORM PIPING (SIZE AS INDICATED)
--- Z" EMST ---	EMERGENCY STORM PIPING (SIZE AS INDICATED)
--- Z" USAN ---	UNDERSLAB SANITARY PIPING (SIZE AS INDICATED)
--- Z" UST ---	UNDERSLAB STORM PIPING (SIZE AS INDICATED)
--- Z" UV ---	UNDERSLAB VENT PIPING (SIZE AS INDICATED)
--- Z" V ---	VENT PIPING (SIZE AS INDICATED)
--- Z" NPW ---	NON-POTABLE WATER PIPING (SIZE AS INDICATED)
--- Z" NG ---	NATURAL GAS PIPING (SIZE AS INDICATED)

PLUMBING PIPING SYMBOLS (ONE-LINE)	
	BALANCING VALVE
	BALL VALVE
	GATE VALVE
	GLOBE VALVE
	BUTTERFLY VALVE
	2-WAY CONTROL VALVE
	3-WAY CONTROL VALVE
	ANGLE VALVE (GATE)
	ANGLE VALVE (GLOBE)
	PRESSURE RELIEF VALVE
	PRESSURE REDUCING VALVE
	PRESSURE REGULATING VALVE
	SPRING CHECK VALVE
	SWING CHECK VALVE
	SOLENOID VALVE
	ELECTRICALLY ACTUATED VALVE
	TRIPLE DUTY VALVE
	GAS COCK
	CIRCUIT SETTER BALANCING VALVE
	PLUG VALVE
	NEEDLE VALVE
	QUICK OPENING VALVE
	QUICK CLOSING VALVE
	WYE STRAINER
	WYE STRAINER W/ BLOWDOWN (BALL)
	WYE STRAINER W/ BLOWDOWN (GATE)
	BASKET STRAINER (SIMPLEX)
	BASKET STRAINER (DUPEX)
	REDUCED PRESSURE ZONE (BALL VALVES)
	REDUCED PRESSURE ZONE (GATE VALVES)
	PIPE TURNING UP
	PIPE TURNING DOWN
	PIPE BRANCH UP
	PIPE BRANCH DN
	CONCENTRIC REDUCER
	ECCENTRIC REDUCER
	PIPE CAP
	PIPE BREAK
	PIPE PLUG
	UNION
	MANUAL AIR VENT
	DECK PLATE CLEANOUT
	WALL CLEANOUT / CLEANOUT
	FLOOR DRAIN / ROOF DRAIN
	HOSE BIBB / NON-FREEZE HOSE BIBB
	FRESH AIR INLET
	WATER HAMMER ARRESTOR
	SINGLE BLIND FLANGE
	DOUBLE BLIND FLANGE
	POINT OF CONNECTION
	POINT OF DISCONNECTION
	THERMOMETER
	PRESSURE GAUGE
	PUMP

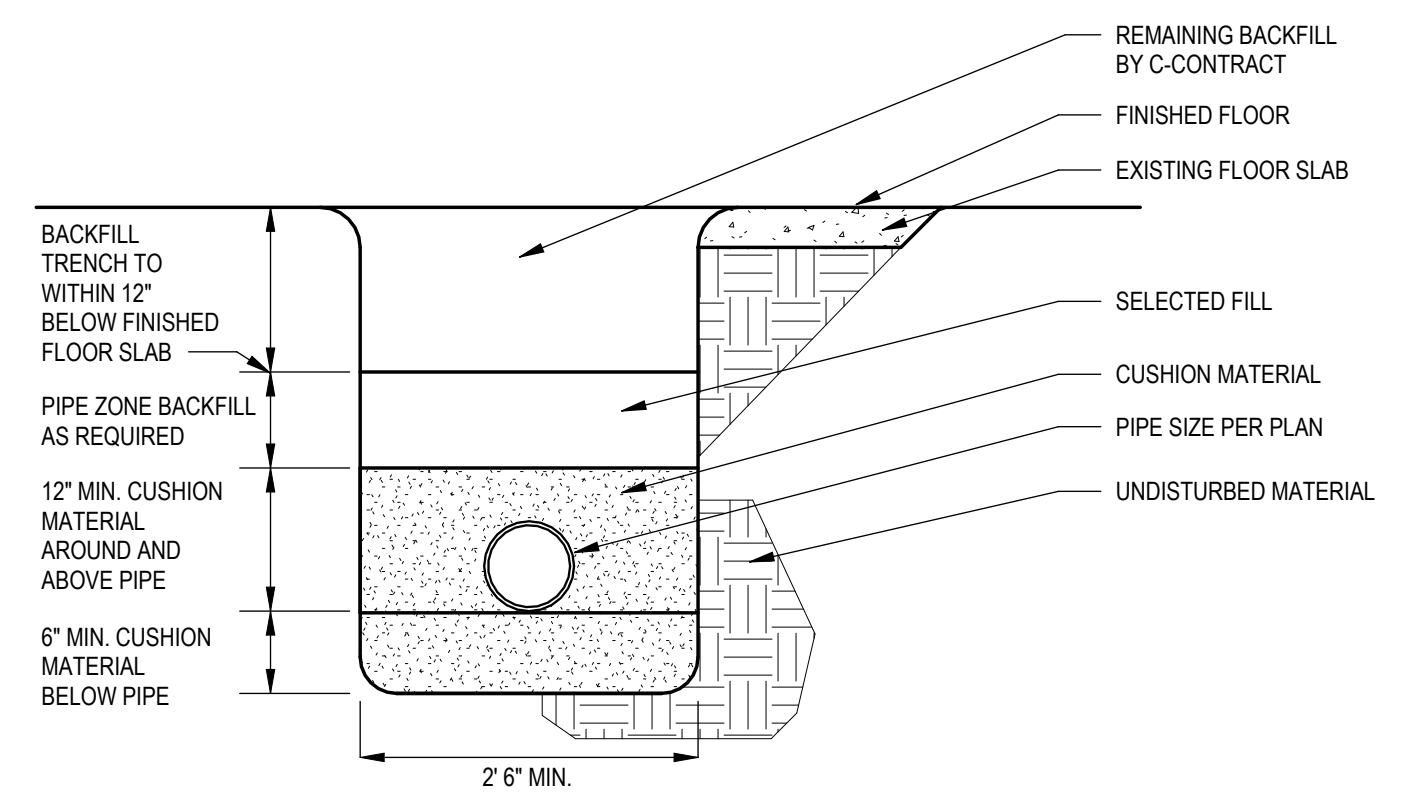

**3 PIPE TRENCH DETAIL**  
NOT TO SCALE

PLUMBING FIXTURE									
TAG	ITEM	MANUFACTURER & MODEL #	WASTE	VENT	CW	HW	ITEM DESCRIPTION	FITTINGS/ACCESSORIES OR DESIGN DATA	
DPCO	DECK PLATE CLEANOUT	JAY R. SMITH / 4020 SERIES	4"				ADJUSTABLE FLOOR CLEANOUT WITH POLISHED BRONZE COVER	NA	
CU	COMBINATION UNIT	Acom Engineering / LR1418-CT-2-04-MBRS-1.28GPF-FVH-FVT-SW	3"	2"	1 1/2"	1 1/2"	STAINLESS STEEL LIGATURE RESISTANT COMBINATION WATER CLOSET AND LAVATORY WITH 1.28 GPF FLUSH VALVE. ORIENTATION TO MATCH PLANS.	FURNISH MANUFACTURER'S WALL SLEEVE FOR CMU CONSTRUCTION. COORDINATE INSTALLATION WITH DIRECTOR'S REPRESENTATIVE. PROVIDE WITH PNEUMATIC LAV METERING VALVE AND FLUSH VALVE EXTENSION.	

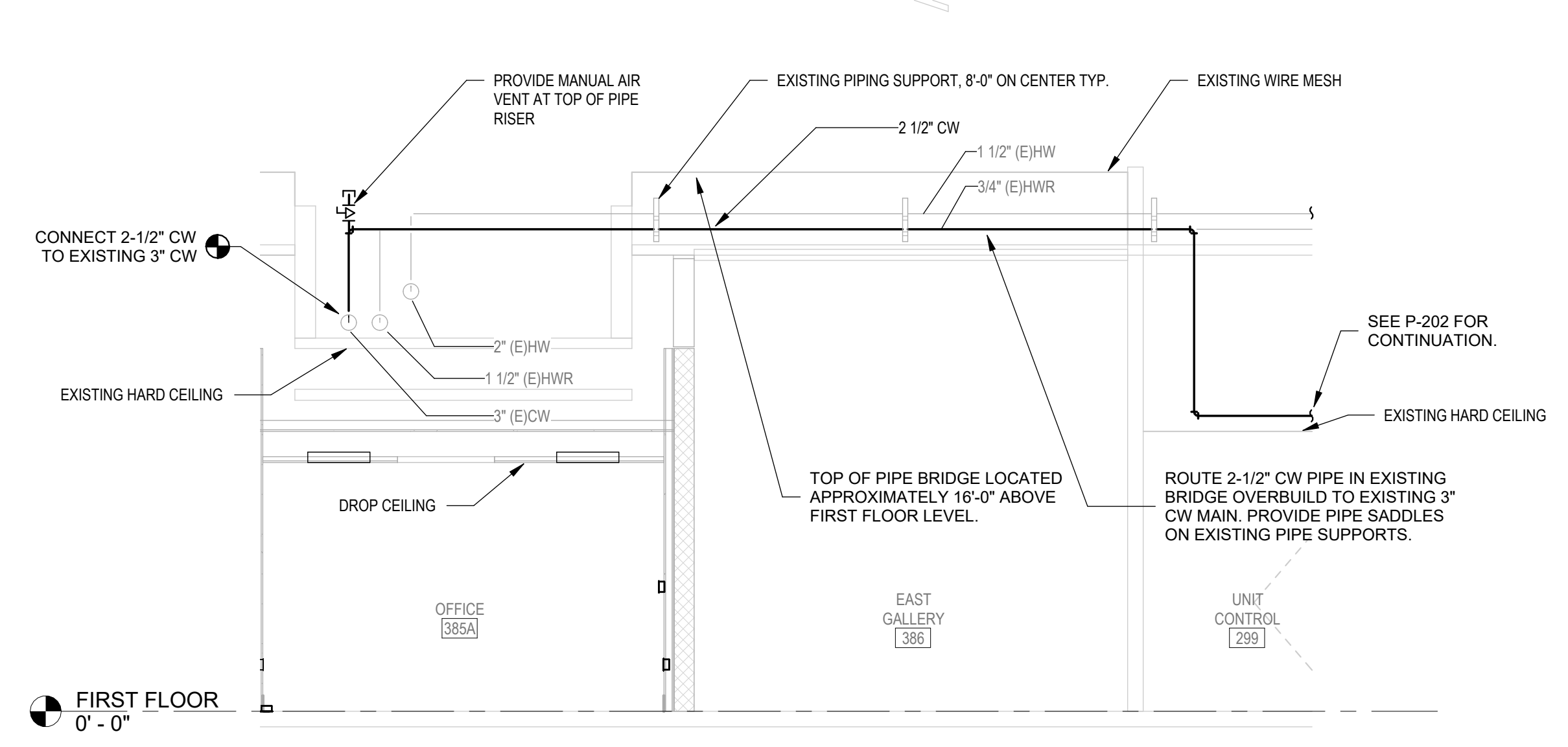

**NOTES:**  
1. PLUMBING WORK SHALL BE PERFORMED FROM ABOVE AS TO NOT DISTURB EXISTING CEILING SYSTEM.  
2. SECTION SHOWS TYPICAL ARRANGEMENT FOR EXISTING PIPE BRIDGE. REFER TO THIS SECTION FOR WHEN ROUTING CONDENSATE PIPING INDICATED ON P-100'S.

**2 PIPE BRIDGE SECTION VIEW**  
NOT TO SCALE

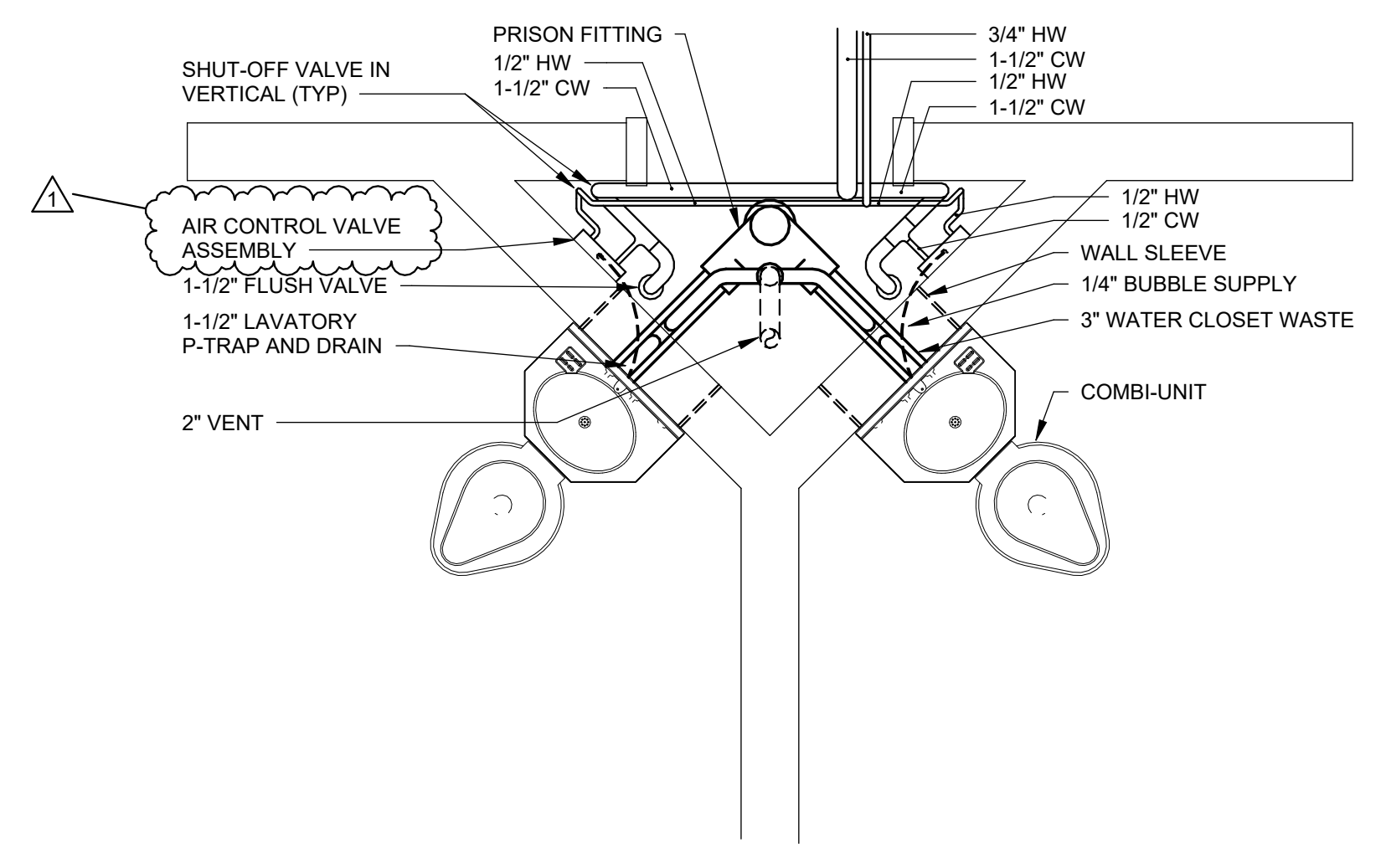

**1 COMBI-UNIT CHASE DETAIL**  
NOT TO SCALE

FIRE ALARM / SECURITY ABBREVIATIONS	
AFFIG	ABOVE FINISHED FLOOR/GRADE
€	CENTERLINE
CSP	CENTRAL SAFETY UNIT
°	DEGREE(S)
DTR	DECOMMISSIONED TO REMOVE
DWG	DRAWING
ETR	EXISTING TO REMAIN
FACP	FIRE ALARM CONTROL PANEL
ISS	INTERCOM SUBSTATION
JCI	JOHNSON CONTROLS INTERNATIONAL
JCSS	JOHNSON CONTROL SECURITY SYSTEMS
MAX	MAXIMUM
MIN	MINIMUM
PTZ	PAN, TILT, ZOOM
SF	SQUARE FOOT/FEET
TYP	TYPICAL
UON	UNLESS OTHERWISE NOTED
VESDA	VERY EARLY SMOKE DETECTION APPARATUS
VPS	VESDA POWER SUPPLY

FIRE ALARM / SECURITY SYMBOLS	
	AIR ASPIRATION SMOKE DETECTOR PORT (PROVIDED BY JCI / SIMPLEX) SUBSCRIPT R - REMOVED/REPLACED CEILING
	ELECTRIFIED DOOR LOCKING HARDWARE WITH LATCH BOLT MONITORING AND DOOR POSITION MONITORING (PROVIDED BY C-CONTRACT)
	DOOR POSITION SWITCH (PROVIDED BY C-CONTRACT)
	INTERCOM SUBSTATION (AS MANUFACTURED BY GUHM CISH25)
	GUARD TOUR SYSTEM CHECK STATION SUBSCRIPT DTR - DECOMMISSIONED, ELECTRICAL CONTRACTOR SHALL DISCONNECT AND REMOVE
	FIXED CAMERA STATION
	PTZ CAMERA STATION
	FIRE ALARM CONTROL PANEL
	VERY EARLY SMOKE DETECTION APPARATUS PANEL (PROVIDED BY JCI / SIMPLEX)
	I/O MODULE (PROVIDED BY JCI / SIMPLEX)
	VESDA RELAY STAX (PROVIDED BY JCI / SIMPLEX)
	VESDA POWER SUPPLY (PROVIDED BY JCI / SIMPLEX)
	VESDA WORKSTATION
	SMOKE DETECTOR (PROVIDED BY JCI / SIMPLEX)
	HEAT DETECTOR (PROVIDED BY JCI / SIMPLEX)

GENERAL	
	NUMBER IN CIRCLE, WITH OR WITHOUT ARROW OR LEADER, REFER TO THE CODED NOTE TO MATCHING NUMBER
	NUMBER IN DIAMOND, WITH OR WITHOUT ARROW OR LEADER, REFER TO THE REMOVAL CODED NOTE WITH THE MATCHING NUMBER
	DETAIL / PLAN NUMBER
	DRAWING NUMBER
<b>GENERAL NOTES</b>	
1. REFER TO CIVIL, STRUCTURAL, ARCHITECTURAL, MECHANICAL, AND PLUMBING DRAWINGS FOR SYMBOLS ASSOCIATED WITH WORK, EQUIPMENT, ETC. BY OTHER(S).	
2. ALL WORK SHOWN ON THE ELECTRICAL DRAWINGS SHALL BE BY THE ELECTRICAL CONTRACTOR UNLESS OTHERWISE INDICATED.	
3. CONDUIT RUNS SHOWN ARE DIAGRAMMATIC UON. EXACT LOCATION OF ALL CONDUIT RUNS SHALL BE DETERMINED IN THE FIELD. COORDINATE INSTALLATIONS AND AVOID CONFLICT WITH PIPING, DUCTWORKS, ACCESS DOORS AND WORK BY OTHER TRADES.	
4. CONCEAL CONDUITS AND/OR WIRING WITHIN WALLS, UNDER FLOORS AND/OR ABOVE SUSPENDED CEILINGS WHEREVER POSSIBLE.	
5. GENERAL NOTES APPLY TO ALL CONTRACT DRAWINGS.	
6. PROVIDE ANY AND ALL EQUIPMENT LIFTS TO ACCOMPLISH TASKS. CONTRACTOR SHALL FOLLOW ALL FACILITY RESTRICTIONS/LIMITATIONS FOR UTILIZING LIFTS. COORDINATE LIFT RESTRICTIONS/LIMITATIONS WITH OWNER.	
7. ALL CONDUIT SHALL BE 3/4" UNLESS OTHERWISE NOTED.	
8. PROVIDE PULL STRING IN ALL CONDUIT AND PULL BOXES. ALL CONDUIT SHALL HAVE PLASTIC BUSHINGS INSTALLED AT OPEN ENDS PRIOR TO PULLING WIRE.	
9. ALL PULL BOXES SHALL BE FLUSH MOUNTED OR CONCEALED UNLESS OTHERWISE NOTED.	
10. ALL BACK BOXES MOUNTED WITHIN FIRE RATED PARTITIONS SHALL MEET THE FIRE RATING OF THE PARTITION AS REQUIRED BY CODE.	
11. UTILIZE VELCRO STRAPS FOR CABLE MANAGEMENT.	
12. PROVIDE PULL BOX EVERY 150' OR 180° IN CONDUIT BENDS FOR COMMUNICATION CONDUITS.	
13. ALL CONDUIT, WIRING, AND ELECTRICAL EQUIPMENT SHALL BE INSTALLED AND GROUNDED IN ACCORDANCE WITH THE LATEST STANDARDS OF THE NATIONAL & STATE ELECTRICAL CODES AND ANY APPLICABLE LOCAL REGULATIONS.	
14. JCI/SIMPLEX SHALL COMPLETE WORK AS SHOWN ON ES DRAWINGS AND IDENTIFIED IN SECTION 012100 ALLOWANCES.	



envision  
ARCHITECTS

**UNIFORM CODE STATEMENT:**  
TO THE BEST OF THE REGISTERED DESIGN PROFESSIONAL'S KNOWLEDGE, BELIEF, AND PROFESSIONAL JUDGEMENT, THESE PLANS AND/OR SPECIFICATIONS ARE IN COMPLIANCE WITH THE 2020 UNIFORM CODE.

**ENERGY CODE COMPLIANCE STATEMENT:**  
TO THE BEST OF THE REGISTERED DESIGN PROFESSIONAL'S KNOWLEDGE, BELIEF, AND PROFESSIONAL JUDGEMENT, THESE PLANS AND/OR SPECIFICATIONS ARE IN COMPLIANCE WITH THE 2020 ENERGY CODE.

**WARNING:**  
THE ALTERATION OF THIS MATERIAL IN ANY WAY UNLESS DONE UNDER THE DIRECTION OF A COMPARABLE PROFESSIONAL, I.E. ARCHITECT FOR AN ARCHITECT, ENGINEER FOR AN ENGINEER OR LANDSCAPE ARCHITECT FOR A LANDSCAPE ARCHITECT, IS A VIOLATION OF THE NEW YORK STATE EDUCATION LAW AND/OR REGULATIONS AND IS A CLASS B MISDEMEANOR.

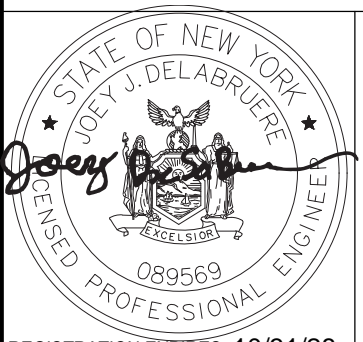

REGISTRATION EXPIRES: 10/31/28

CONTRACT: **ELECTRICAL**

TITLE:  
RENOVATE 70 BEDROOM UNITS: HARDEN WALLS

LOCATION:  
FINGER LAKES RESIDENTIAL CENTER  
250 AUBURN RD,  
LANSING, NY

CLIENT:  
OFFICE OF CHILDREN AND FAMILY SERVICES

MARK	DATE	DESCRIPTION
1	10/10/2025	ADDENDUM #2
0	12/24/2024	BID DOCUMENTS
PROJECT NUMBER: Q1894-E		
DESIGNED BY: MPI		
DRAWN BY: CDS		
FIELD CHECK:		
APPROVED:		
SHEET TITLE:		

LEGEND, ABBREVIATIONS AND SYMBOLS

DRAWING NUMBER:  
**ES-001**

SHEET: OF

SHEET SIZE 30" x 42". DRAWING IS NOT TO SCALE WHEN PRINTED IN ALL OTHER SHEET SIZES.

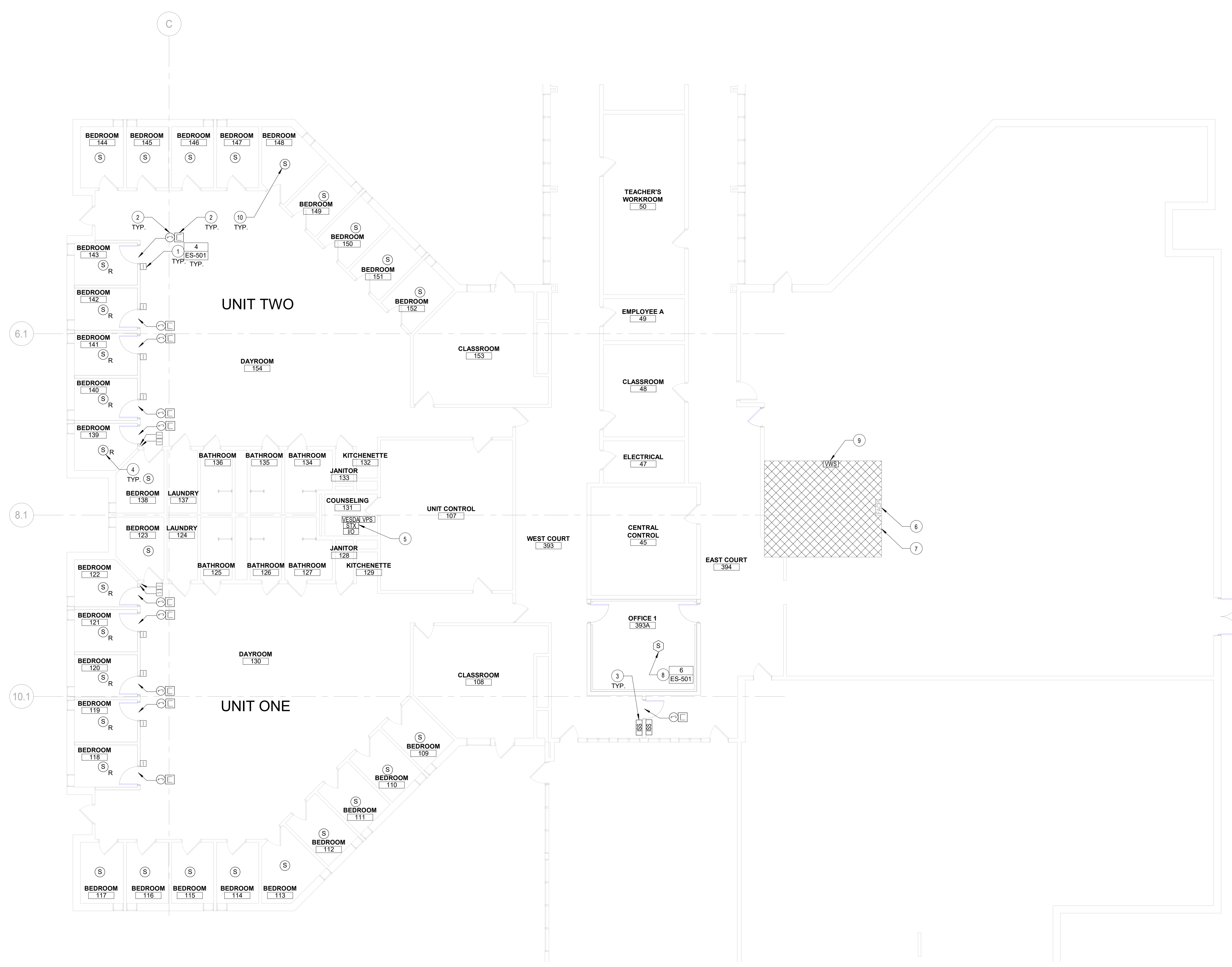

1 FIRST FLOOR PLAN UNITS 1 & 2  
1/8" = 1'-0"

**GENERAL NOTES**

- REFER TO ES-001 - LEGEND, ABBREVIATIONS AND SYMBOLS FOR REMOVAL NOTES AND ADDITIONAL INFORMATION.
- REFER TO ES-601 - FIRE ALARM RISER DIAGRAM FOR ADDITIONAL INFORMATION.
- REFER TO ES-501 - FIRE ALARM DETAILS FOR ADDITIONAL INFORMATION.

**CODED NOTES**

- UPON COMPLETION OF DOOR INSTALLATION, REINSTALL GUARD TOUR CHECK STATION ON FRAME ON STRIKE SIDE AT 60" AFF.
- PROVIDE 3/4" CONDUIT WITH PULL STRING FROM TOP OF DOOR FRAME ON STRIKE SIDE TO 6" ABOVE CEILING INTO PLATFORM FOR DOOR POSITION SWITCH AND ELECTRIC DOOR LOCK.
- PROVIDE 2-GANG BACK BOX MOUNTED AT 48" AFF TO CENTER OF DEVICE WITH 3/4" CONDUIT TO 6" ABOVE CEILING INTO PLATFORM WITH BUSHING ON CONDUIT END. INSTALL WIRING COILED ABOVE CEILING THROUGH CONDUIT AND TERMINATE TO INTERCOM SUBSTATION AS REQUIRED. WIRE COILED ABOVE CEILING IS PROVIDED BY JCI/JCSS THROUGH THE FACILITY'S DIRECT ARRANGEMENT WITH JCI/JCSS, INDEPENDENT OF THIS CONTRACT. CONTRACTOR TO COORDINATE WITH THE DIRECTOR'S REPRESENTATIVE AS NEEDED.
- JCISIMPLEX SHALL PROVIDE VANDAL RESISTANT VERY EARLY SMOKE DETECTION APPARATUS (VESDA PANEL) AIR ASPIRATION SMOKE DETECTOR PORT AND SECURITY COVER AND ROUTE TO ASSOCIATED VESDA SYSTEM. JCI SIMPLEX SHALL PROVIDE VESDA SAMPLING HEAD AND SECURITY COVER IN CENTER OF 24" CEILING PLANK NEAR CENTER OF ROOM. REFER TO ARCHITECTURAL REFLECTIVE CEILING PLANS FOR EXACT LOCATION AND COORDINATION WITH OTHER DEVICES. FOLLOW MANUFACTURER'S RECOMMENDATIONS FOR INSTALLATION OF SAMPLING HEAD. CONSTRUCTION CONTRACT SHALL PROVIDE CEILING CUTOUT.
- JCISIMPLEX SHALL PROVIDE (40) PORT VERY EARLY SMOKE DETECTION APPARATUS (VESDA PANEL) SYSTEM, VESDA RELAY STAK, VESDA POWER SUPPLY, AND IO MODULE LOCATED ON PLATFORM LEVEL. JCISIMPLEX SHALL CONNECT VESDA PANEL TO EXISTING FIRE ALARM CONTROL PANEL. ELECTRICAL CONTRACTOR SHALL RECONNECT POWER SUPPLY TO EXISTING 120VAC CIRCUIT IN PLATFORM LEVEL.
- EXISTING FIRE ALARM CONTROL PANEL SHALL REMAIN.
- APPROXIMATE LOCATION OF CENTRAL ROOM.
- JCISIMPLEX SHALL PROVIDE SMOKE DETECTOR MOUNTED TO CEILING AND # 18S FROM SMOKE DETECTOR TO NEAREST SMOKE DETECTOR. ELECTRICAL CONTRACTOR SHALL PROVIDE BACK BOX AND CONDUIT FROM SMOKE DETECTOR TO NEAREST SMOKE DETECTOR. REFER TO ARCHITECTURAL REFLECTIVE CEILING PLANS FOR EXACT LOCATION AND COORDINATION WITH OTHER DEVICES. CONSTRUCTION CONTRACT SHALL PROVIDE CEILING CUTOUT.
- PROVIDE VESDA WORKSTATION (TRUE SITE WORKSTATION), MONITOR, SOFTWARE, AND REQUIRED PROGRAMMING.
- JCISIMPLEX SHALL PROVIDE VANDAL RESISTANT VERY EARLY SMOKE DETECTION APPARATUS (VESDA PANEL) AIR ASPIRATION SMOKE DETECTOR PORT AND SECURITY COVER IN PREVIOUSLY REMOVED LOCATION AND ROUTE TO ASSOCIATED VESDA SYSTEM. FOLLOW MANUFACTURER'S RECOMMENDATIONS FOR INSTALLATION OF SAMPLING HEAD. ELECTRICAL CONTRACTOR IS RESPONSIBLE FOR ALL CUTTING AND PATCHING REQUIRED FOR SYSTEM INSTALLATION TO MATCH EXISTING CONDITIONS.



UNIFORM CODE STATEMENT:  
TO THE BEST OF THE REGISTERED DESIGN PROFESSIONAL'S KNOWLEDGE, BELIEF, AND PROFESSIONAL JUDGEMENT, THESE PLANS AND/OR SPECIFICATIONS ARE IN COMPLIANCE WITH THE 2020 UNIFORM CODE.

ENERGY CODE COMPLIANCE STATEMENT:  
TO THE BEST OF THE REGISTERED DESIGN PROFESSIONAL'S KNOWLEDGE, BELIEF, AND PROFESSIONAL JUDGEMENT, THESE PLANS AND/OR SPECIFICATIONS ARE IN COMPLIANCE WITH THE 2020 ENERGY CODE.

WARNING:  
THE ALTERATION OF THIS MATERIAL IN ANY WAY UNLESS DONE UNDER THE DIRECTION OF A COMPARABLE PROFESSIONAL, I.E. ARCHITECT FOR AN ARCHITECT, ENGINEER FOR AN ENGINEER OR LANDSCAPE ARCHITECT FOR A LANDSCAPE ARCHITECT, IS A VIOLATION OF THE NEW YORK STATE EDUCATION LAW AND/OR REGULATIONS AND IS A CLASS B MISDEMEANOR.

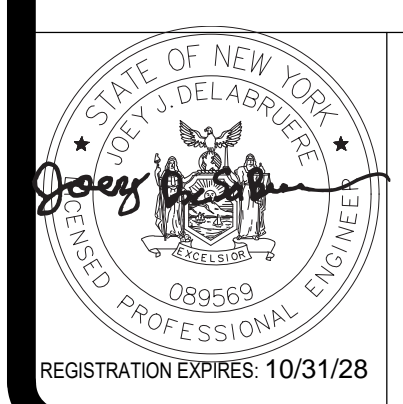

CONTRACT: **ELECTRICAL**

TITLE: **RENOVATE 70 BEDROOM UNITS: HARDEN WALLS**

LOCATION: **FINGER LAKES RESIDENTIAL CENTER  
250 AUBURN RD,  
LANSING, NY**

CLIENT: **OFFICE OF CHILDREN AND FAMILY SERVICES**

MARK	DATE	DESCRIPTION
1	10/10/2025	ADDENDUM #2
0	12/24/2024	BID DOCUMENTS

PROJECT NUMBER: **Q1894-E**

DESIGNED BY: **MPI**

DRAWN BY: **CDS**

FIELD CHECK:

APPROVED:

SHEET TITLE: **FIRST FLOOR PLAN UNITS 1 & 2**

DRAWING NUMBER: **ES-101**

SHEET: **OF**

Autodesk Docs://085008 OGS Q1894 Finger Lakes Wall Hardening of 70 Bedroom Units/Finger Lakes Residential Center\_Secur\_R23.vt 10/19/2025 11:24:23 AM 3/24/2025 8:07:46 ET

SHEET SIZE 30" x 42". DRAWING IS NOT TO SCALE WHEN PRINTED IN ALL OTHER SHEET SIZES.

Autodesk Docs://085008 OGS Q1894 Finger Lakes Wall Hardening of 70 Bedroom Units/Finger Lakes Residential Center\_Secur\_R23.rvt  
10/19/2025 11:24:25 AM  
3/24/2025 8:07 AM

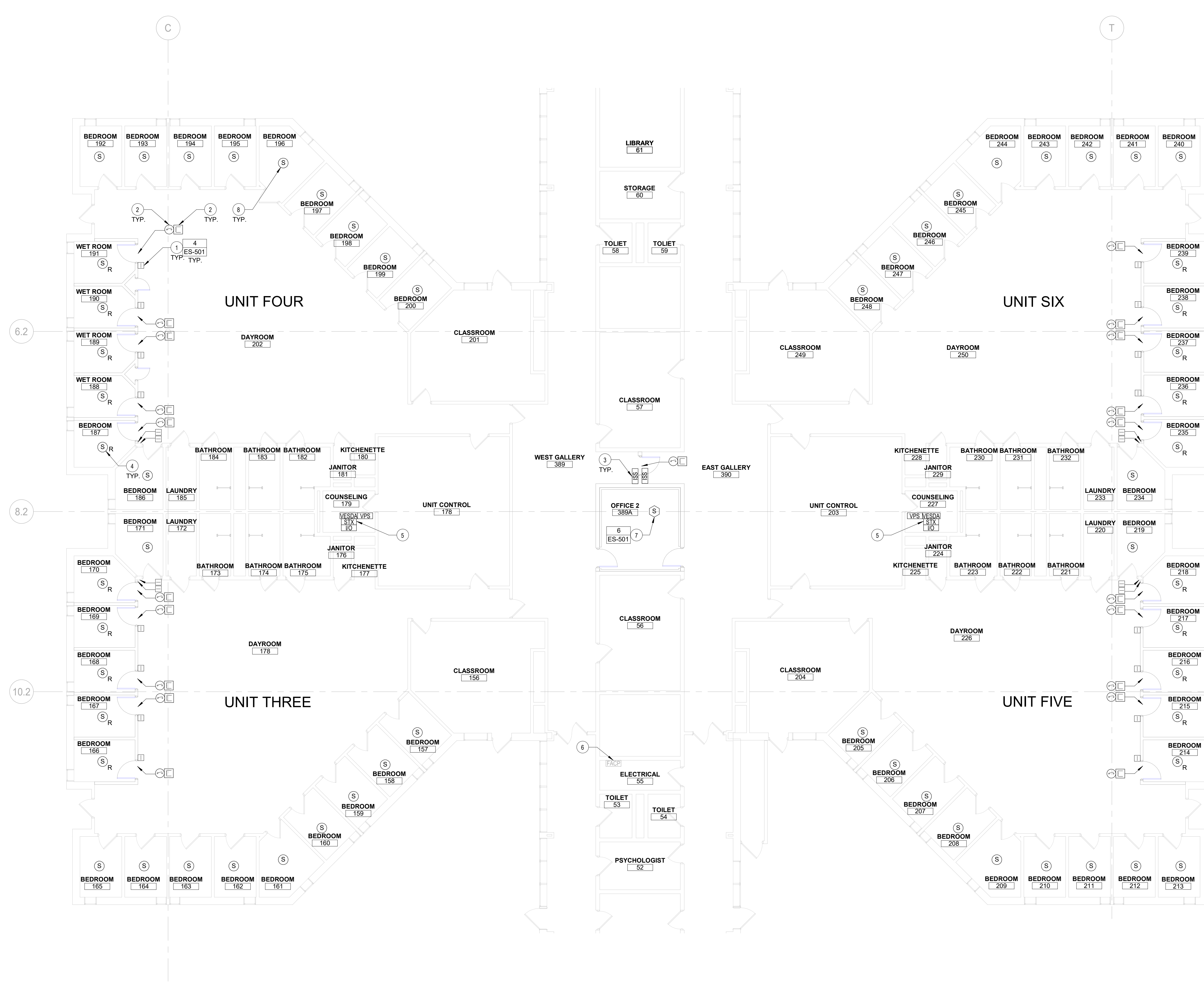

**GENERAL NOTES**

- REFER TO ES-001 - LEGEND, ABBREVIATIONS AND SYMBOLS FOR REMOVAL NOTES AND ADDITIONAL INFORMATION.
- REFER TO ES-601 - FIRE ALARM RISER DIAGRAM FOR ADDITIONAL INFORMATION.
- REFER TO ES-501 - FIRE ALARM DETAILS FOR ADDITIONAL INFORMATION.

**CODED NOTES**

- UPON COMPLETION OF DOOR INSTALLATION, REINSTALL GUARD TOUR CHECK STATION ON FRAME ON STRIKE SIDE AT 60" AFF.
- PROVIDE 3/4" CONDUIT WITH PULL STRING FROM TOP OF DOOR FRAME ON STRIKE SIDE TO 6" ABOVE CEILING INTO PLATFORM FOR DOOR POSITION SWITCH AND ELECTRIC DOOR LOCK.
- PROVIDE 2-GANG BACK BOX MOUNTED AT 48" AFF TO CENTER OF DEVICE WITH 3/4" CONDUIT TO 6" ABOVE CEILING INTO PLATFORM WITH BUSHING ON CONDUIT END. INSTALL WIRING COILED ABOVE CEILING THROUGH CONDUIT AND TERMINATE TO INTERCOM SUBSTATION AS REQUIRED. WIRE COILED ABOVE CEILING IS PROVIDED BY JCI/JCSS THROUGH THE FACILITY'S DIRECT ARRANGEMENT WITH JCI/JCSS. INDEPENDENT OF THIS CONTRACT, CONTRACTOR TO COORDINATE WITH THE DIRECTOR'S REPRESENTATIVE AS NEEDED.
- JCI/SIMPLEX SHALL PROVIDE VANDAL RESISTANT VERY EARLY SMOKE DETECTION APPARATUS (VESDA PANEL) AIR ASPIRATION SMOKE DETECTOR PORT AND SECURITY COVER AND ROUTE TO ASSOCIATED VESDA SYSTEM. JCI/SIMPLEX SHALL PROVIDE VESDA SAMPLING HEAD AND SECURITY COVER IN CENTER OF 24" CEILING PLANK NEAR CENTER OF ROOM. REFER TO ARCHITECTURAL REFLECTIVE CEILING PLANS FOR EXACT LOCATION AND COORDINATION WITH OTHER DEVICES. FOLLOW MANUFACTURER'S RECOMMENDATIONS FOR INSTALLATION OF SAMPLING HEAD. CONSTRUCTION CONTRACT SHALL PROVIDE CEILING CUTOUT.
- JCI/SIMPLEX SHALL PROVIDE (40) PORT VERY EARLY SMOKE DETECTION APPARATUS (VESDA PANEL) SYSTEM, VESDA RELAY STAX, VESDA POWER SUPPLY, AND I/O MODULE LOCATED ON PLATFORM LEVEL. JCI/SIMPLEX SHALL CONNECT VESDA PANEL TO EXISTING FIRE ALARM CONTROL PANEL. ELECTRICAL CONTRACTOR SHALL RECONNECT POWER SUPPLY TO EXISTING 120VAC CIRCUIT IN PLATFORM LEVEL.
- EXISTING FIRE ALARM CONTROL PANEL SHALL REMAIN.
- JCI/SIMPLEX SHALL PROVIDE SMOKE DETECTOR MOUNTED TO CEILING AND 2# 18S FROM SMOKE DETECTOR TO NEAREST SMOKE DETECTOR. ELECTRICAL CONTRACTOR SHALL PROVIDE BACK BOX AND CONDUIT FROM SMOKE DETECTOR TO NEAREST SMOKE DETECTOR. REFER TO ARCHITECTURAL REFLECTIVE CEILING PLANS FOR EXACT LOCATION AND COORDINATION WITH OTHER DEVICES. CONSTRUCTION CONTRACT SHALL PROVIDE CEILING CUTOUT.
- JCI/SIMPLEX SHALL PROVIDE VANDAL RESISTANT VERY EARLY SMOKE DETECTION APPARATUS (VESDA PANEL) AIR ASPIRATION SMOKE DETECTOR PORT AND SECURITY COVER IN PREVIOUSLY REMOVED LOCATION AND ROUTE TO ASSOCIATED VESDA SYSTEM. FOLLOW MANUFACTURER'S RECOMMENDATIONS FOR INSTALLATION OF SAMPLING HEAD. ELECTRICAL CONTRACTOR IS RESPONSIBLE FOR ALL CUTTING AND PATCHING REQUIRED FOR SYSTEM INSTALLATION TO MATCH EXISTING CONDITIONS.

**1** FIRST FLOOR PLAN UNITS 3 - 6  
1/8" = 1'-0"



**UNIFORM CODE STATEMENT:**  
TO THE BEST OF THE REGISTERED DESIGN PROFESSIONAL'S KNOWLEDGE, BELIEF, AND PROFESSIONAL JUDGEMENT, THESE PLANS AND/OR SPECIFICATIONS ARE IN COMPLIANCE WITH THE 2020 UNIFORM CODE.

**ENERGY CODE COMPLIANCE STATEMENT:**  
TO THE BEST OF THE REGISTERED DESIGN PROFESSIONAL'S KNOWLEDGE, BELIEF, AND PROFESSIONAL JUDGEMENT, THESE PLANS AND/OR SPECIFICATIONS ARE IN COMPLIANCE WITH THE 2020 ENERGY CODE.

**WARNING:**  
THE ALTERATION OF THIS MATERIAL, IN ANY WAY, UNLESS DONE UNDER THE DIRECTION OF A COMPARABLE PROFESSIONAL, I.E. ARCHITECT FOR AN ARCHITECT, ENGINEER FOR AN ENGINEER OR LANDSCAPE ARCHITECT FOR A LANDSCAPE ARCHITECT, IS A VIOLATION OF THE NEW YORK STATE EDUCATION LAW AND/OR REGULATIONS AND IS A CLASS B MISDEMEANOR.

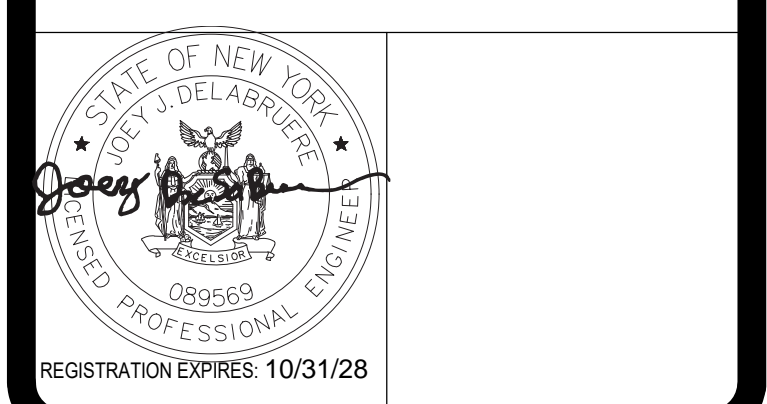

CONTRACT: **ELECTRICAL**

TITLE: **RENOVATE 70 BEDROOM UNITS: HARDEN WALLS**

LOCATION: **FINGER LAKES RESIDENTIAL CENTER  
250 AUBURN RD,  
LANSING, NY**

CLIENT: **OFFICE OF CHILDREN AND FAMILY SERVICES**

MARK	DATE	DESCRIPTION
1	10/10/2025	ADDENDUM #2
0	12/24/2024	BID DOCUMENTS

PROJECT NUMBER: **Q1894-E**

DESIGNED BY: **MP1**

DRAWN BY: **CDS**

FIELD CHECK:

APPROVED:

SHEET TITLE:

SHEET SIZE 30" x 42". DRAWING IS NOT TO SCALE WHEN PRINTED IN ALL OTHER SHEET SIZES.

Autodesk Docs://085008 OGS Q1894 Finger Lakes Wall Hardening of 70 Bedroom Units/Finger Lakes Residential Center\_Secur\_R23.rvt 10/19/2025 11:24:25 AM 3/24/2025 8:07:46 ET

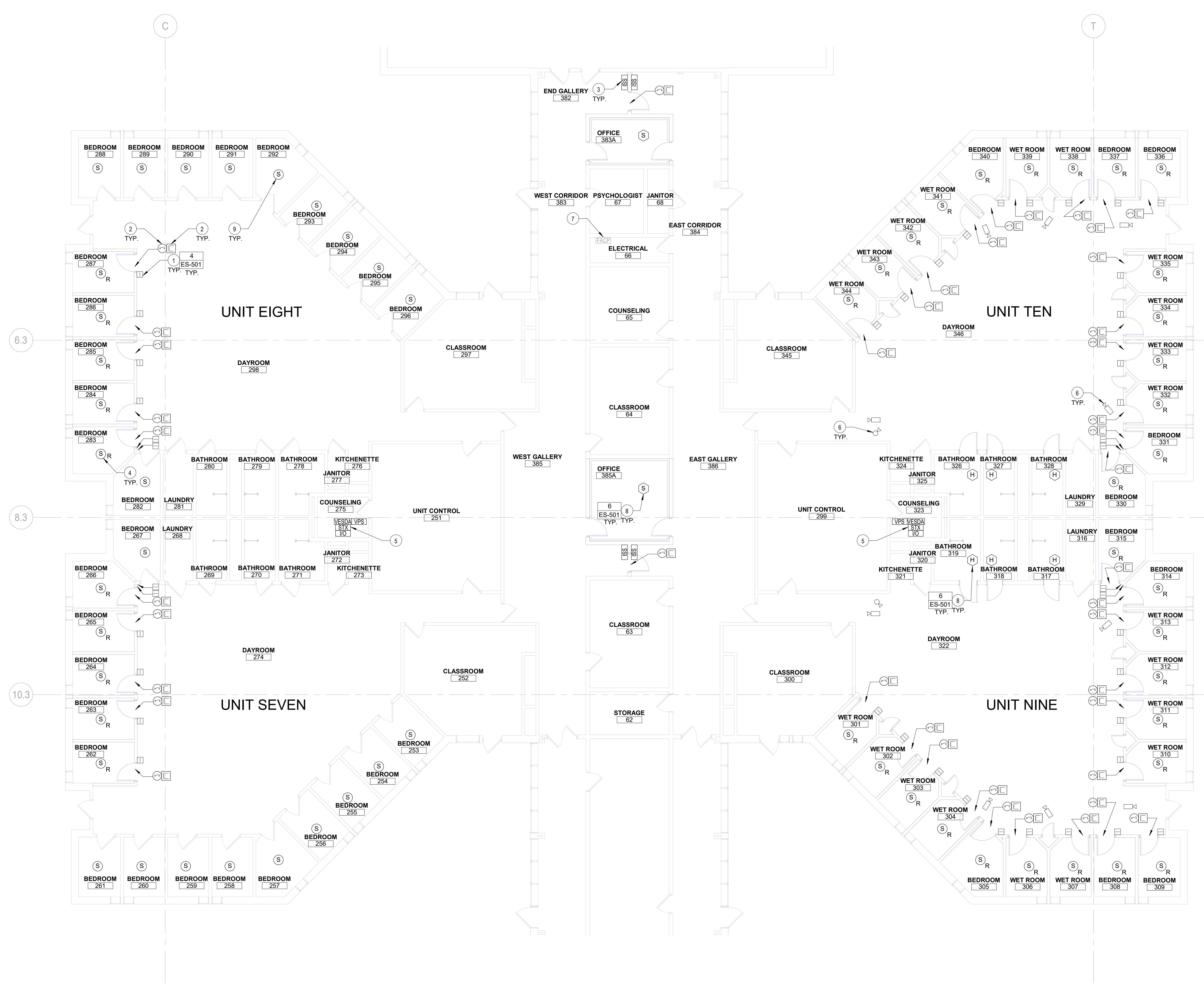

1 FIRST FLOOR PLAN UNITS 7 - 10  
1/8" = 1'-0"

**GENERAL NOTES**

- REFER TO ES-001 - LEGEND, ABBREVIATIONS AND SYMBOLS FOR REMOVAL NOTES AND ADDITIONAL INFORMATION.
- REFER TO ES-001 - FIRE ALARM RISER DIAGRAM FOR ADDITIONAL INFORMATION.
- REFER TO ES-501 - FIRE ALARM DETAILS FOR ADDITIONAL INFORMATION.

**CODED NOTES**

- UPON COMPLETION OF DOOR INSTALLATION, REINSTALL GUARD TOUR CHECK STATION ON FRAME ON STRIKE SIDE AT 60" AFF.
- PROVIDE 3/4" CONDUIT WITH PULL STRING FROM TOP OF DOOR FRAME ON STRIKE SIDE TO 6" ABOVE CEILING INTO PLATFORM FOR DOOR POSITION SWITCH AND ELECTRIC DOOR LOCK.
- PROVIDE 2-GANG BACK BOX MOUNTED AT 48" AFF TO CENTER OF DEVICE WITH 3/4" CONDUIT TO 6" ABOVE CEILING INTO PLATFORM WITH BUSHING ON CONDUIT END. INSTALL WIRING COILED ABOVE CEILING THROUGH CONDUIT AND TERMINATE TO INTERCOM SUBSTATION AS REQUIRED. WIRE COILED ABOVE CEILING IS PROVIDED BY JCI/JCSS THROUGH THE FACILITY'S DIRECT ARRANGEMENT WITH JCI/JCSS, INDEPENDENT OF THIS CONTRACT. CONTRACTOR TO COORDINATE WITH THE DIRECTOR'S REPRESENTATIVE AS NEEDED.
- JCI/SIMPLEX SHALL PROVIDE VANDAL RESISTANT VERY EARLY SMOKE DETECTION APPARATUS (VESDA PANEL) AIR ASPIRATION SMOKE DETECTOR PORT AND SECURITY COVER AND ROUTE TO ASSOCIATED VESDA SYSTEM. JCI/SIMPLEX SHALL PROVIDE VESDA SAMPLING HEAD AND SECURITY COVER IN CENTER OF 24" CEILING PLANK NEAR CENTER OF ROOM. REFER TO ARCHITECTURAL REFLECTIVE CEILING PLANS FOR EXACT LOCATION AND COORDINATION WITH OTHER DEVICES. FOLLOW MANUFACTURER'S RECOMMENDATIONS FOR INSTALLATION OF SAMPLING HEAD. CONSTRUCTION CONTRACT SHALL PROVIDE CEILING CUTOUT.
- JCI/SIMPLEX SHALL PROVIDE (40) PORT VERY EARLY SMOKE DETECTION APPARATUS (VESDA PANEL) SYSTEM, VESDA RELAY STAX, VESDA POWER SUPPLY, AND I/O MODULE LOCATED ON PLATFORM LEVEL. JCI/SIMPLEX SHALL CONNECT VESDA PANEL TO EXISTING FIRE ALARM CONTROL PANEL. ELECTRICAL CONTRACTOR SHALL RECONNECT POWER SUPPLY TO EXISTING 120VAC CIRCUIT IN PLATFORM LEVEL.
- JCI/JCSS SHALL REINSTALL CAMERA AFTER UNIT 10 WORK IS COMPLETED AND ACCEPTED. JCI/JCSS INSTALLATION OF CAMERA WILL BE COMPLETED THROUGH THE FACILITY'S DIRECT ARRANGEMENT WITH JCI/JCSS, INDEPENDENT OF THIS CONTRACT. CONTRACTOR TO COORDINATE WITH THE DIRECTOR'S REPRESENTATIVE AS NEEDED.
- EXISTING FIRE ALARM CONTROL PANEL SHALL REMAIN.
- JCI/SIMPLEX SHALL PROVIDE SMOKE/HEAT DETECTOR MOUNTED TO CEILING AND 2818'S FROM SMOKE/HEAT DETECTOR TO NEAREST SMOKE DETECTOR. ELECTRICAL CONTRACTOR SHALL PROVIDE BACK BOX AND CONDUIT FROM SMOKE/HEAT DETECTOR TO NEAREST SMOKE DETECTOR. REFER TO ARCHITECTURAL REFLECTIVE CEILING PLANS FOR EXACT LOCATION AND COORDINATION WITH OTHER DEVICES. CONSTRUCTION CONTRACT SHALL PROVIDE CEILING CUTOUT.
- JCI/SIMPLEX SHALL PROVIDE VANDAL RESISTANT VERY EARLY SMOKE DETECTION APPARATUS (VESDA PANEL) AIR ASPIRATION SMOKE DETECTOR PORT AND SECURITY COVER IN PREVIOUSLY REMOVED LOCATION AND ROUTE TO ASSOCIATED VESDA SYSTEM. FOLLOW MANUFACTURER'S RECOMMENDATIONS FOR INSTALLATION OF SAMPLING HEAD. ELECTRICAL CONTRACTOR IS RESPONSIBLE FOR ALL CUTTING AND PATCHING REQUIRED FOR SYSTEM INSTALLATION TO MATCH EXISTING CONDITIONS.



**UNIFORM CODE STATEMENT:**  
TO THE BEST OF THE REGISTERED DESIGN PROFESSIONAL'S KNOWLEDGE, BELIEF, AND PROFESSIONAL JUDGEMENT, THESE PLANS AND/OR SPECIFICATIONS ARE IN COMPLIANCE WITH THE 2020 UNIFORM CODE.

**ENERGY CODE COMPLIANCE STATEMENT:**  
TO THE BEST OF THE REGISTERED DESIGN PROFESSIONAL'S KNOWLEDGE, BELIEF, AND PROFESSIONAL JUDGEMENT, THESE PLANS AND/OR SPECIFICATIONS ARE IN COMPLIANCE WITH THE 2020 ENERGY CODE.

**WARNING:**  
THE ALTERATION OF THIS MATERIAL, IN ANY WAY, UNLESS DONE UNDER THE DIRECTION OF A COMPARABLE PROFESSIONAL, I.E. ARCHITECT FOR AN ARCHITECT, ENGINEER FOR AN ENGINEER OR LANDSCAPE ARCHITECT FOR A LANDSCAPE ARCHITECT, IS A VIOLATION OF THE NEW YORK STATE EDUCATION LAW AND REGULATIONS AND IS A CLASS B MISDEMEANOR.

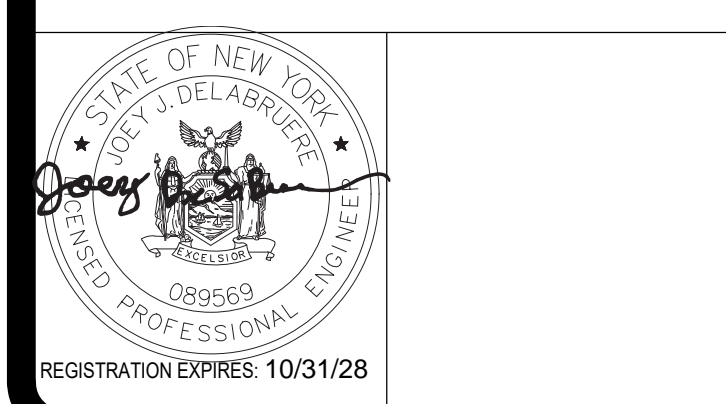

CONTRACT:	<b>ELECTRICAL</b>
TITLE:	RENOVATE 70 BEDROOM UNITS. HARDEN WALLS
LOCATION:	FINGER LAKES RESIDENTIAL CENTER 250 AUBURN RD. LANSING, NY
CLIENT:	OFFICE OF CHILDREN AND FAMILY SERVICES

MARK	DATE	DESCRIPTION
1	10/10/2025	ADDENDUM #2
0	12/24/2024	BID DOCUMENTS

PROJECT NUMBER: **Q1894-E**

DESIGNED BY: MPI  
DRAWN BY: CDS

FIELD CHECK:  
APPROVED:  
SHEET TITLE:

FIRST FLOOR PLAN UNITS 7 - 10

DRAWING NUMBER:  
**ES-103**

SHEET: OF

SHEET SIZE 30" x 42". DRAWING IS NOT TO SCALE WHEN PRINTED IN ALL OTHER SHEET SIZES.

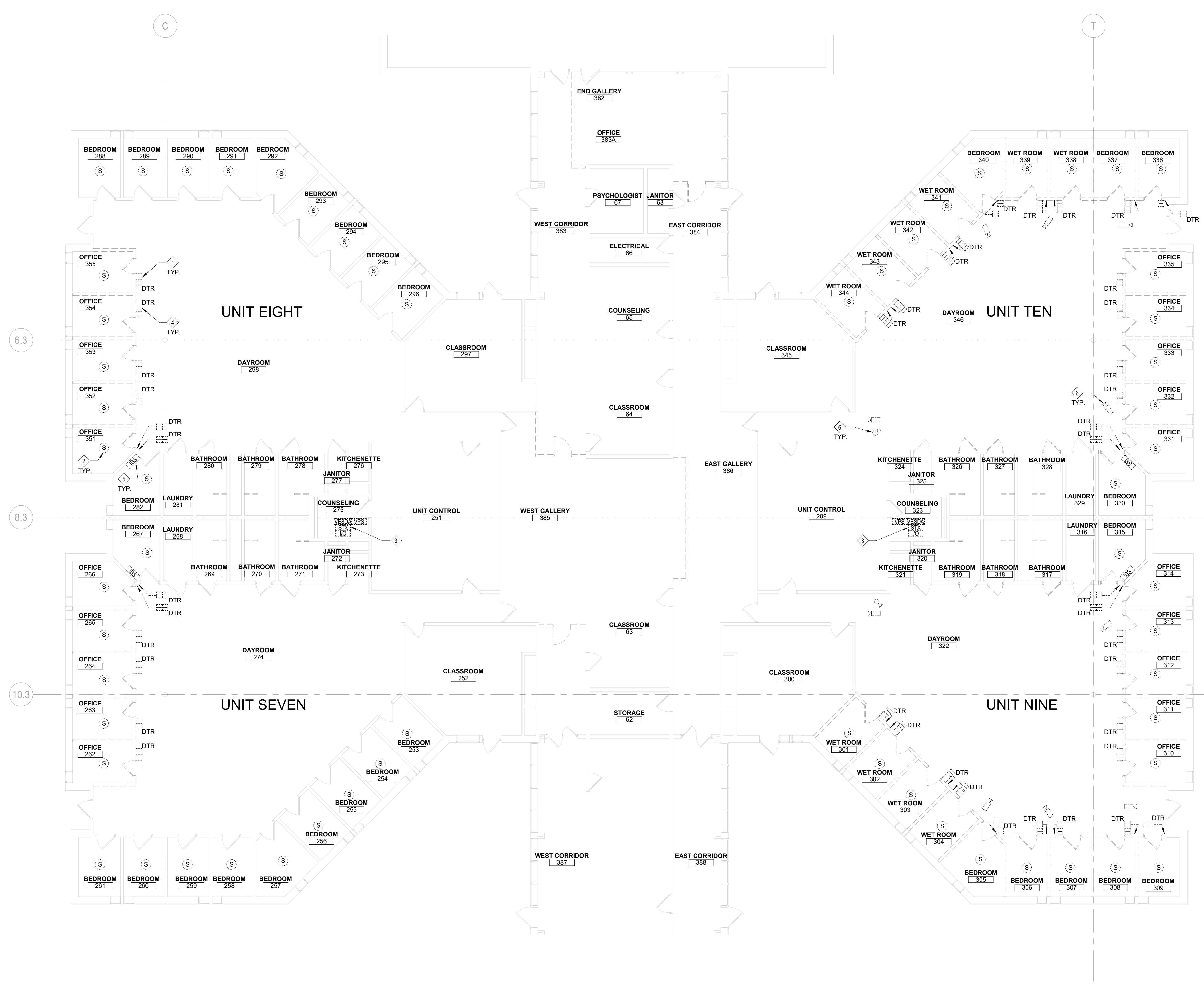

**GENERAL NOTES**

- REFER TO ES-001 - LEGEND, ABBREVIATIONS AND SYMBOLS FOR REMOVAL NOTES AND ADDITIONAL INFORMATION.
- REFER TO ES-601 - FIRE ALARM RISER DIAGRAM FOR ADDITIONAL INFORMATION.
- REFER TO ES-501 - FIRE ALARM DETAILS FOR ADDITIONAL INFORMATION.

**REMOVAL CODED NOTES**

- DISCONNECT, REMOVE, AND STORE GUARD TOUR CHECK STATION FOR REINSTALLATION IN SAFE LOCATION FOR DOOR REPLACEMENT.
- JCI/SIMPLEX SHALL DISCONNECT AND REMOVE EXISTING VANDAL RESISTANT VERY EARLY SMOKE DETECTION APPARATUS (VESDA PANEL) AIR ASPIRATION SMOKE DETECTOR PORT AND EXISTING SECURITY COVER.
- JCI/SIMPLEX SHALL DISCONNECT AND REMOVE EXISTING VERY EARLY SMOKE DETECTION APPARATUS (VESDA PANEL) AND EXISTING VESDA PANEL POWER SUPPLIES LOCATED ON PLATFORM LEVEL. REMOVAL SHALL INCLUDE LOW VOLTAGE WIRING BACK TO FACP IN ITS ENTIRETY. ELECTRICAL CONTRACTOR SHALL MAINTAIN 120VAC CIRCUIT IN SAFE CONDITION DURING RENOVATION FOR REUSE BY THIS CONTRACT.
- DISCONNECT AND REMOVE GUARD TOUR CHECK STATION.
- DISCONNECT AND REMOVE INTERCOM SUBSTATION. REMOVAL SHALL INCLUDE BACKBOX, CONDUIT AND WIRING BACK TO SOURCE. PROVIDE ALL CUTTING AND PATCHING REQUIRED FOR REMOVAL TO MATCH EXISTING CONDITIONS.
- JCI/CSS SHALL DISCONNECT, REMOVE, AND STORE CAMERAS IN A SAFE LOCATION. JCI/CSS CAMERA REMOVAL OPERATION WILL BE COMPLETED THROUGH THE FACILITY'S DIRECT ARRANGEMENT WITH JCI/CSS, INDEPENDENT OF THIS CONTRACT. CONTRACTOR SHALL PROTECT EXISTING WIRING. CONTRACTOR TO COORDINATE WITH THE DIRECTOR'S REPRESENTATIVE AS NEEDED.

**1 FIRST FLOOR REMOVALS PLAN UNITS 7 - 10**



**NEW YORK STATE** Office of General Services  
DESIGN & CONSTRUCTION

CONSULTANT:  
CERTIFICATE OF AUTHORIZATION # 018342

**UNIFORM CODE STATEMENT:**  
TO THE BEST OF THE REGISTERED DESIGN PROFESSIONAL'S KNOWLEDGE, BELIEF, AND PROFESSIONAL JUDGEMENT, THESE PLANS AND/OR SPECIFICATIONS ARE IN COMPLIANCE WITH THE 2020 UNIFORM CODE.

**ENERGY CODE COMPLIANCE STATEMENT:**  
TO THE BEST OF THE REGISTERED DESIGN PROFESSIONAL'S KNOWLEDGE, BELIEF, AND PROFESSIONAL JUDGEMENT, THESE PLANS AND/OR SPECIFICATIONS ARE IN COMPLIANCE WITH THE 2020 ENERGY CODE.

**WARNING:**  
THE ALTERATION OF THIS MATERIAL IN ANY WAY UNLESS DONE UNDER THE DIRECTION OF A COMPARABLE PROFESSIONAL, I.E. ARCHITECT FOR AN ARCHITECT, ENGINEER FOR AN ENGINEER OR LANDSCAPE ARCHITECT FOR A LANDSCAPE ARCHITECT, IS A VIOLATION OF THE NEW YORK STATE EDUCATION LAW AND/OR REGULATIONS AND IS A CLASS B MISDEMEANOR.

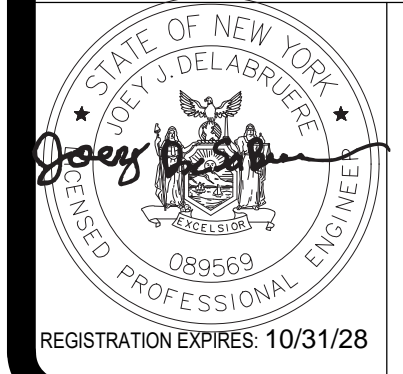

**CONTRACT:** ELECTRICAL

**TITLE:** RENOVATE 70 BEDROOM UNITS: HARDEN WALLS

**LOCATION:** FINGER LAKES RESIDENTIAL CENTER  
250 AUBURN RD,  
LANSING, NY

**CLIENT:** OFFICE OF CHILDREN AND FAMILY SERVICES

MARK	DATE	DESCRIPTION
1	10/10/2025	ADDENDUM #2
0	12/24/2024	BID DOCUMENTS

**PROJECT NUMBER:** Q1894-E

**DESIGNED BY:** MPI

**DRAWN BY:** CDS

**FIELD CHECK:**

**APPROVED:**

**SHEET TITLE:** FIRST FLOOR REMOVALS PLAN UNITS 7 - 10

**DRAWING NUMBER:** ESD-103

**SHEET:** OF

Autodesk Docs://085008 OGS Q1894 Finger Lakes Wall Hardening of 70 Bedroom Units/Finger Lakes Residential Center\_Secur\_R23.rvt  
10/10/2025 11:24:31 AM  
3/24/2025 8:07 AM